

INTERNATIONAL HYDROGRAPHIC ORGANIZATION

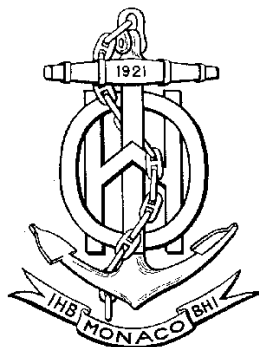

Special Publication No. 52, Appendix 2

COLOUR & SYMBOL SPECIFICATIONS FOR ECDIS

Edition 4.3 – January 2008

and its Annex A

IHO ECDIS PRESENTATION LIBRARY

Edition 3.4 – January 2008

C & S MAINTENANCE DOCUMENT

Number 7 – May 2009

DEFERRED AMENDMENT 8

**Published by the
International Hydrographic Bureau**

4, Quai Antoine 1er
B.P. 445 - MC 98011 MONACO Cedex
Principauté de Monaco
Telefax: (377) 93 10 81 40
E-mail: info@ihb.mc
Web-site: www.ihb.shom.fr

Page intentionally left blank

Introduction

Amendments to S-52 Appendix 2 affect primarily the ECDIS manufacturers, though the mariners will benefit from the improvements made. The procedures for amending S-52 Appendix 2 include both immediate and deferred amendments. Definitions and procedures for these amendments are given in S-52 App.2 "Colour & Symbol Specifications for ECDIS" (C&S Specs), section 1.2.4.1, but are as follows:

An amendment in general may be of the following two different types:

- a deferred amendment may contain either:
 - (a) clarifications and deferred correction items, or
 - (b) extension items, which are distributed separately.
- an immediate amendment which contains only items to be applied urgently,

A deferred amendment is not included in any S-52 Appendix 2 document until the new edition which is identified as bringing the deferred amendments into force. However OEMs may apply such deferred amendments at any time after their publication and do not have to wait for the implementation date of the new edition.

An immediate amendment is issued only in exceptional cases. It applies solely to corrections and extensions which directly affect safety of navigation. Immediate amendments have to be implemented to ECDIS under production and in the field at the earliest opportunity. An immediate amendment to the C&S Specs or Presentation Library (PresLib) changes the Edition number. It applies only to corrections, which must not depend on any deferred amendment.

The item number of each amendment item gives the edition number of the C&S Specs or the PresLib to which the amendment item applies. This Edition number will change once an immediate amendment is applied, but does not change for a deferred amendment.

At the end of each immediate amendment, there is a reminder of the current Edition number after the amendment is applied.

Page intentionally left blank

**S-52 APP. 2 – DEFERRED AMENDMENT 8
May 2009**

NOTES

1. These amendments are intended to remind users of S-52 Appendix 2 of the changes approved at the meeting CSMWG 18, Cape Town, May 2008 and to point out how these changes affect C&S Specifications Edition 4.3 and PresLib Edition 3.4 in detail.
2. CHANGE HISTORY OF S-52 APP.2 FROM CSMWG SPECS 4.0 --> 4.3 AND PRESLIB 3.0-->3.4 FROM 1997 TO 2008

'MD' stands for IHO Maintenance Document; 'IA' stands for Immediate Amendment; and 'DA' stands for Deferred Amendment:

Colours & Symbols Specifications (S-52 Appendix 2)

- Edition 4.0 (July 1997) + MD1 IA i01 --> Edition 4.1 (January 1999)
- Edition 4.1 + MD2 DA d02 + MD4 DA d6 --> Edition 4.2 (March 2004)
- Edition 4.2 + MD5 DA d7 → Edition 4.3 (January 2008)

Presentation Library (Annex A to S-52 Appendix 2)

- Edition 3.0 (July 1997) + MD1 IA i01 → Edition 3.1 (January 1999)
- Edition 3.1 + MD 3 IA i04 --> Edition 3.2 (May 2000)
- Edition 3.2 + MD2 DA d02 + MD3 DA d05 + MD4 DA d6 → Edition 3.3 (2004)
- Edition 3.3 + MD5 IA i5 + MD5 DA d7 → Edition 3.4 (January 2008)
- Edition 3.4 + MD7 DA d8 (May 2009)
- Digital versions:
 - PRSLIB03.dai (July 1997),
 - PSLB03_1.dai (December 1998),
 - PSLB03_2.dai (May 2000),
 - PSLB03_3.dai (March 2004),
 - PSLB03_4.dai (January 2008),
- Temporary digital files: PSTY03_0.dai (June 1999), PSTY3_2b.dai (October 2001) (see amendment d05.cl.005)
- Paper based description of symbols:
 - Addendum to Part I, Users' Manual (2003)
 - Addendum to Part I, Users' Manual (2007)
 - Addendum to Part I, Users' Manual (2008), Edition 3.4

Edition 3.4 of the PresLib, was triggered by the introduction of new objects, object attributes and attribute values in S-57 Supplement No. 1, issued in January 2007. Edition 4.3 of the PresLib itself is to be set in force in conjunction with the S-57 Supplement No. 1 by 1. January 2008.

TSMAD and CSMWG commonly identified minor deficiencies of PresLib 3.4 and supplement the affected clauses by means of this Maintenance Document No. 7 dated from March 2009 for the following amendments:

INDEX OF ITEMS IN DEFERRED AMENDMENT 8

<u>Item No. PL03.4.d8.co.1</u>	Correction and Addition to PresLib Look-up table correct DGPS symbol	p. 2
<u>Item No.PL03.4.d8.ad.2</u>	Addition to PresLib Look-up table point and area objects	p. 2
<u>Item No.PL03.4.d8.ad.3</u>	Addition to PresLib symbol description (Users' Manual Addendum) CHECKPOINT and GRIDIRON symbol	p. 39
<u>Item No. PL03.4.d8.co.4</u>	Correction and Addition to List of symbol names & meaning correct several table entries	p. 41

S-52 APP. 2 – DEFERRED AMENDMENT 8

*Throughout this amendment changes to the CSMWG Specs. and the PresLib. are indicated by ~~strikethrough~~ text for deletions and **bold text** for additions.*

Item No. PL03.4.d8.co.1 Correction to PresLib Look-up table
correct DGPS symbol

Item No.PL03.4.d8.ad.2 Addition to PresLib Look-up table
point and area objects

Item No.PL03.4.d8.ad.3 Addition to PresLib symbol description (Users' Manual Addendum)
CHECKPOINT and GRIDIRON symbol

Item No. PL03.4.d8.co.1 Correction to PresLib Look-up table
correct DGPS symbol

Corrected look up table entries see gray shaded entries for **RDOSTA** under Look up table listings contained in Item No.PL03.4.d8.ad.2 below

Item No.PL03.4.d8.ad.2 Addition to PresLib Look-up table
point and area objects

11. LOOK-UP TABLE LISTINGS

The Presentation Library provides five look-up tables:

- 1a. paper chart point symbols (buoys and beacons are similar to the paper chart)
- 1b. simplified point symbols (buoys and beacons are more prominent)
2. line symbols
- 3a. area symbols with plain boundaries (for general use)
- 3b. area symbols with symbolized boundaries (for large scale display)

The ECDIS should provide all of these and make the options available to the mariner.

Some of the look-up table entries describe the presentation of mariners' navigational objects. Please see Part II of the PresLib for further details and definitions of mariners' navigational object classes.

See 8.3 for further explanation how to use the look-up tables.

11.1 Look-Up Table Listing for Object Type Point 'P'

11.1.1 Look-up Table for paper chart point symbolization

* *** PAPER CHART POINTS ***

* *** This is the look-up table for point symbolization. ***

* *** For edition 3.4 Preslib, dated January 2008 *****

*

* Each line contains minimum 6 fields:

- * 1. field - code of the object class
- * 2. field - attribute combination
- * 3. field - symbolization instruction
- * 4. field - display priority
- * 5. field - radar
- * 6. field - IMO display category
- * 7. field - viewing group (optional)

*

* Each field entry is framed by "" and fields are separated by ','.

*

* Please note, that the entries to this table must be in

* alphabetic order (sorted by the class code).

*

* This table has 2 sections:

*

* - The first section contains symbolization instructions for

* standard S-57 'real world' objects:

* - The second section contains symbolization instructions for

* non-standard (class code in lowercase) objects:

*

* default for symbolization failure; must be the first entry to look-up table

"#####", "", "SY(QUESMRK1)", "5", "O", "STANDARD", "21010"

"BUISGL","FUNCTN33CONVIS1OBJNAM","SY(POSGEN03);TX(OBJNAM,3,2,2,'15110',1,0,CHBLK,26)","6","O","STANDARD","22220"
 "BUISGL","FUNCTN20CONVIS1","SY(BUIREL13)","6","O","STANDARD","22220"
 "BUISGL","FUNCTN21CONVIS1","SY(BUIREL13)","6","O","STANDARD","22220"
 "BUISGL","FUNCTN22CONVIS1","SY(BUIREL14)","6","O","STANDARD","22220"
 "BUISGL","FUNCTN23CONVIS1","SY(BUIREL14)","6","O","STANDARD","22220"
 "BUISGL","FUNCTN24CONVIS1","SY(BUIREL14)","6","O","STANDARD","22220"
 "BUISGL","FUNCTN25CONVIS1","SY(BUIREL14)","6","O","STANDARD","22220"
 "BUISGL","FUNCTN26CONVIS1","SY(BUIREL15)","6","O","STANDARD","22220"
 "BUISGL","FUNCTN27CONVIS1","SY(BUIREL15)","6","O","STANDARD","22220"
 "BUISGL","FUNCTN33CONVIS1","SY(POSGEN03)","6","O","STANDARD","22220"
 "BUISGL","FUNCTN35CONVIS1","SY(TNKCON12)","6","O","STANDARD","22220"
 "BUISGL","FUNCTN33OBJNAM","SY(POSGEN03);TX(OBJNAM,3,2,2,'15110',1,0,CHBLK,26)","4","O","OTHER","32220"
 "BUISGL","CONVIS1","SY(BUISGL11)","6","O","STANDARD","22220"
 "BUISGL","FUNCTN20","SY(BUIREL01)","4","O","OTHER","32220"
 "BUISGL","FUNCTN21","SY(BUIREL01)","4","O","OTHER","32220"
 "BUISGL","FUNCTN22","SY(BUIREL04)","4","O","OTHER","32220"
 "BUISGL","FUNCTN23","SY(BUIREL04)","4","O","OTHER","32220"
 "BUISGL","FUNCTN24","SY(BUIREL04)","4","O","OTHER","32220"
 "BUISGL","FUNCTN25","SY(BUIREL04)","4","O","OTHER","32220"
 "BUISGL","FUNCTN26","SY(BUIREL05)","4","O","OTHER","32220"
 "BUISGL","FUNCTN27","SY(BUIREL05)","4","O","OTHER","32220"
 "BUISGL","FUNCTN33","SY(POSGEN03)","4","O","OTHER","32220"
 "BUISGL","FUNCTN35","SY(TNKCON02)","4","O","OTHER","32220"
 "CGUSTA","SY(CGUSTA02)","7","O","OTHER","38030"
 "CHKPNT","SY(CHKPNT01)","4","S","OTHER","32410"
 "CRANES","SY(CRANES01)","4","O","OTHER","32440"
 "CTNARE","SY(CHINFO06)","4","O","STANDARD","26050"
 "CTRPNT","SY(POSGEN04)","4","O","OTHER","32250"
 "CTSARE","SY(CHINFO07)","4","O","STANDARD","26250"
 "CURENT","SY(CURDEF01)","5","O","OTHER","33000"
 "CURENT","ORIENTCURVEL","SY(CURENT01,ORIENT);TE('%4.1f kn',CURVEL,3,1,2,'15110',1,-1,CHBLK,31)","5","O","OTHER","33060"
 "CURENT","ORIENT","SY(CURENT01,ORIENT)","5","O","OTHER","33060"
 "DAMCON","CATDAM3","SY(CHINFO06)","4","O","STANDARD","22010"
 "DAYMAR","SY(DAYSQR21);TE('bn %s',OBJNAM,2,1,2,'15110',-1,-1,CHBLK,21)","7","O","STANDARD","27025"
 "DAYMAR","TOPSHP19","SY(DAYSQR21);TE('bn %s',OBJNAM,2,1,2,'15110',-1,-1,CHBLK,21)","7","O","STANDARD","27025"
 "DAYMAR","TOPSHP20","SY(DAYSQR21);TE('bn %s',OBJNAM,2,1,2,'15110',-1,-1,CHBLK,21)","7","O","STANDARD","27025"
 "DAYMAR","TOPSHP21","SY(DAYSQR21);TE('bn %s',OBJNAM,2,1,2,'15110',-1,-1,CHBLK,21)","7","O","STANDARD","27025"
 "DAYMAR","TOPSHP24","SY(DAYTRI21);TE('bn %s',OBJNAM,2,1,2,'15110',-1,-1,CHBLK,21)","7","O","STANDARD","27025"
 "DAYMAR","TOPSHP25","SY(DAYTRI25);TE('bn %s',OBJNAM,2,1,2,'15110',-1,-1,CHBLK,21)","7","O","STANDARD","27025"
 "DISMAR","SY(DISMAR03);TX(INFORM,2,1,2,'15110',2,0,CHBLK,21)","7","O","OTHER","32430"
 "DISMAR","CATDIS1","SY(DISMAR04);TX(INFORM,2,1,2,'15110',2,0,CHBLK,21)","7","O","OTHER","32430"
 "DMPGRD","SY(CHINFO07)","4","O","STANDARD","26240"
 "FOGSIG","SY(FOGSIG01)","6","O","STANDARD","27080"
 "FORSTC","SY(FORSTC01)","4","O","OTHER","32220"
 "FORSTC","CONVIS1","SY(FORSTC11)","4","O","STANDARD","22220"
 "FSHFAC","SY(FSHHAV01)","4","O","OTHER","34040"

"FSHFAC","CATFIF1","SY(FSHFAC03)","4","O","OTHER","34040"
 "FSHFAC","CATFIF2","SY(FSHFAC02)","4","O","OTHER","34040"
 "FSHFAC","CATFIF3","SY(FSHFAC02)","4","O","OTHER","34040"
 "FSHFAC","CATFIF4","SY(FSHFAC02)","4","O","OTHER","34040"
 "GATCON","SY(GATCON04)","8","O","STANDARD","22010"
 "GATCON","CATGAT2","SY(GATCON04)","8","O","STANDARD","22010"
 "GATCON","CATGAT3","SY(GATCON04)","8","O","OTHER","32440"
 "GATCON","CATGAT4","SY(GATCON03)","8","O","OTHER","32440"
 "GRIDRN","SY(GRIDRN01)","5","S","OTHER","32460"
 "HRBFAC","SY(CHINFO07)","4","O","OTHER","32410"
 "HRBFAC","CATHAF1","SY(ROLROL01)","4","O","OTHER","32410"
 "HRBFAC","CATHAF4","SY(HRBFAC09)","4","O","OTHER","32410"
 "HRBFAC","CATHAF5","SY(SMCFAC02)","4","O","OTHER","32410"
 "HULKES","SY(HULKES01)","5","O","DISPLAYBASE","12410"
 "ICNARE","SY(CHINFO07)","4","O","STANDARD","26250"
 "LIGHTS","CS(LIGHTS05)","8","O","STANDARD","27070"
 "LITFLT","SY(LITFLT01);TE('by %s',OBJNAM,2,1,2,'15110',-1,-1,CHBLK,21)","8","O","STANDARD","27010"
 "LITVES","SY(LITVES01);TE('LiV %s',OBJNAM,2,1,2,'15110',-1,-1,CHBLK,21)","8","O","STANDARD","27011"
 "LNDARE","SY(LNDARE01);TX(OBJNAM,1,2,2,'15110',0,1,CHBLK,26);CS(QUAPOS01)","4","O","DISPLAYBASE","12010"
 "LNDELV","SY(POSGEN04);TE('%3.0lf m',ELEVAT,3,2,2,'15110',1,0,CHBLK,28)","4","O","OTHER","32010"
 "LNDMRK","SY(POSGEN01)","4","O","OTHER","32220"
 "LNDMRK","CATLMK17FUNCTN33CONVIS1","SY(TOWERS03);TX(OBJNAM,3,2,2,'15110',1,-1,CHBLK,26)","6","O","STANDARD","22220"
 "LNDMRK","CATLMK15FUNCTN20CONVIS1","SY(BUIREL13)","6","O","STANDARD","22220"
 "LNDMRK","CATLMK15FUNCTN21CONVIS1","SY(BUIREL13)","6","O","STANDARD","22220"
 "LNDMRK","CATLMK17FUNCTN20CONVIS1","SY(BUIREL13)","6","O","STANDARD","22220"
 "LNDMRK","CATLMK17FUNCTN21CONVIS1","SY(BUIREL13)","6","O","STANDARD","22220"
 "LNDMRK","CATLMK20FUNCTN20CONVIS1","SY(BUIREL13)","6","O","STANDARD","22220"
 "LNDMRK","CATLMK20FUNCTN21CONVIS1","SY(BUIREL13)","6","O","STANDARD","22220"
 "LNDMRK","CATLMK20FUNCTN26CONVIS1","SY(BUIREL15)","6","O","STANDARD","22220"
 "LNDMRK","CATLMK20FUNCTN27CONVIS1","SY(BUIREL15)","6","O","STANDARD","22220"
 "LNDMRK","CATLMK17FUNCTN33","SY(TOWERS01);TX(OBJNAM,3,2,2,'15110',1,-1,CHBLK,26)","4","O","OTHER","32220"
 "LNDMRK","CATLMK1CONVIS1","SY(CAIRNS11)","6","O","STANDARD","22220"
 "LNDMRK","CATLMK3CONVIS1","SY(CHIMNY11)","6","O","STANDARD","22220"
 "LNDMRK","CATLMK4CONVIS1","SY(DSHAER11)","6","O","STANDARD","22220"
 "LNDMRK","CATLMK5CONVIS1","SY(FLGSTF01)","6","O","STANDARD","22220"
 "LNDMRK","CATLMK6CONVIS1","SY(FLASTK11)","6","O","STANDARD","22220"
 "LNDMRK","CATLMK7CONVIS1","SY(MSTCON14)","6","O","STANDARD","22220"
 "LNDMRK","CATLMK8CONVIS1","SY(POSGEN03)","6","O","STANDARD","22220"
 "LNDMRK","CATLMK9CONVIS1","SY(MONUMT12)","6","O","STANDARD","22220"
 "LNDMRK","CATLMK10CONVIS1","SY(MONUMT12)","6","O","STANDARD","22220"
 "LNDMRK","CATLMK12CONVIS1","SY(MONUMT12)","6","O","STANDARD","22220"
 "LNDMRK","CATLMK13CONVIS1","SY(MONUMT12)","6","O","STANDARD","22220"
 "LNDMRK","CATLMK15CONVIS1","SY(DOMES011)","6","O","STANDARD","22220"
 "LNDMRK","CATLMK16CONVIS1","SY(RASCAN11)","6","O","STANDARD","22220"
 "LNDMRK","CATLMK17CONVIS1","SY(TOWERS03)","6","O","STANDARD","22220"
 "LNDMRK","CATLMK18CONVIS1","SY(WNDMIL12)","6","O","STANDARD","22220"
 "LNDMRK","CATLMK19CONVIS1","SY(WIMCON11)","6","O","STANDARD","22220"
 "LNDMRK","CATLMK20CONVIS1","SY(POSGEN03)","6","O","STANDARD","22220"

"LNDMRK","CATLMK20FUNCTN20","SY(BUIREL01)","4","O","OTHER","32220"
 "LNDMRK","CATLMK1","SY(CAIRNS01)","4","O","OTHER","32220"
 "LNDMRK","CATLMK3","SY(CHIMNY01)","4","O","OTHER","32220"
 "LNDMRK","CATLMK4","SY(DSHAER01)","4","O","OTHER","32220"
 "LNDMRK","CATLMK5","SY(FLGSTF01)","4","O","OTHER","32220"
 "LNDMRK","CATLMK6","SY(FLASTK01)","4","O","OTHER","32220"
 "LNDMRK","CATLMK7","SY(MSTCON04)","4","O","OTHER","32220"
 "LNDMRK","CATLMK8","SY(POSGEN03)","4","O","OTHER","32220"
 "LNDMRK","CATLMK9","SY(MONUMT02)","4","O","OTHER","32220"
 "LNDMRK","CATLMK10","SY(MONUMT02)","4","O","OTHER","32220"
 "LNDMRK","CATLMK12","SY(MONUMT02)","4","O","OTHER","32220"
 "LNDMRK","CATLMK13","SY(MONUMT02)","4","O","OTHER","32220"
 "LNDMRK","CATLMK15","SY(DOMES001)","4","O","OTHER","32220"
 "LNDMRK","CATLMK16","SY(RASCAN01)","4","O","OTHER","32220"
 "LNDMRK","CATLMK17","SY(TOWERS01)","4","O","OTHER","32220"
 "LNDMRK","CATLMK18","SY(WNDMIL02)","4","O","OTHER","32220"
 "LNDMRK","CATLMK19","SY(WIMCON01)","4","O","OTHER","32220"
 "LNDMRK","CATLMK20","SY(POSGEN01)","4","O","OTHER","32220"
 "LNDMRK","CONVIS1","SY(POSGEN03)","6","O","STANDARD","22220"
 "LNDRGN","","SY(POSGEN04);TX(OBJNAM,1,2,2,'15110',0,-1,CHBLK,26)","4","O","STANDARD","21060"
 "LOCMAG","","SY(LOCMAG01)","4","O","OTHER","31080"
 "LOGPON","","SY(FLTHAZ02)","4","O","OTHER","34050"
 "M_NPUB","","SY(CHINFO07)","4","O","OTHER","31020"
 "MAGVAR","","SY(MAGVAR01);TX(VALMAG,3,1,2,'15110',1,-1,CHBLK,27)","4","O","OTHER","31080"
 "MARCUL","","SY(MARCUL02)","4","O","STANDARD","26210"
 "MIPARE","","SY(CHINFO06)","4","O","STANDARD","26040"
 "MORFAC","","SY(MORFAC03)","6","O","DISPLAYBASE","12410"
 "MORFAC","CATMOR7BOYSHP3","SY(BOYMOR01)","8","O","STANDARD","27010"
 "MORFAC","CATMOR7BOYSHP6","SY(BOYMOR03)","8","O","STANDARD","27010"
 "MORFAC","CATMOR1","SY(MORFAC03)","6","O","DISPLAYBASE","12410"
 "MORFAC","CATMOR2","SY(MORFAC04)","6","O","DISPLAYBASE","12410"
 "MORFAC","CATMOR3","SY(PILPNT02)","6","O","OTHER","32440"
 "MORFAC","CATMOR5","SY(PILPNT02)","6","O","DISPLAYBASE","12410"
 "MORFAC","CATMOR7","SY(BOYMOR11)","8","O","STANDARD","27010"
 "NEWOBJ","","SY(NEWOBJ01)","6","S","STANDARD","21020"
 "NEWOBJ","SYMINS","CS(SYMINS01)","6","S","STANDARD","21020"
 "OBSTRN","","CS(OBSTRN06)","4","O","OTHER","34050"
 "OBSTRN","CATOBS7VALSOU","SY(FOULGND1)","4","O","OTHER","34051"
 "OBSTRN","CATOBS8VALSOU","SY(FLTHAZ02)","4","O","OTHER","34051"
 "OBSTRN","CATOBS9VALSOU","SY(ACHARE02)","4","O","OTHER","34051"
 "OBSTRN","CATOBS10VALSOU","SY(FLTHAZ02)","4","O","OTHER","34051"
 "OBSTRN","CATOBS7","SY(FOULGND1)","4","O","OTHER","34050"
 "OBSTRN","CATOBS8","SY(FLTHAZ02)","4","O","OTHER","34050"
 "OBSTRN","CATOBS9","SY(ACHARE02)","4","O","OTHER","34050"
 "OBSTRN","CATOBS10","SY(FLTHAZ02)","4","O","OTHER","34050"
 "OBSTRN","WATLEV7","SY(FLTHAZ02)","4","O","DISPLAYBASE","12410"
 "OFSPLF","","SY(OFSPLF01);TE('Prod %s',OBJNAM,3,1,2,'15110',1,-1,CHBLK,21)","5","O","DISPLAYBASE","12210"
 "PILBOP","","SY(PILBOP02);TE('Plt %s',OBJNAM,3,1,2,'15110',1,-1,CHBLK,21)","6","O","STANDARD","28010"
 "PILPNT","","SY(PILPNT02)","5","O","DISPLAYBASE","12410"

"PIPARE", "", "SY(CHINFO07)", "4", "O", "STANDARD", "26230"
 "PIPSOL", "", "", "", "", "", ""
 "PRCARE", "", "SY(PRCARE12)", "5", "O", "STANDARD", "25010"
 "PRDARE", "", "", "", "", "", ""
 "PRDARE", "CATPRA5CONVIS1", "SY(FLASTK11)", "4", "O", "STANDARD", "22220"
 "PRDARE", "CATPRA8CONVIS1", "SY(TNKCON12)", "4", "O", "STANDARD", "22220"
 "PRDARE", "CATPRA9CONVIS1", "SY(WIMCON11)", "4", "O", "STANDARD", "22220"
 "PRDARE", "CATPRA1", "SY(PRDINS02)", "34", "O", "OTHER", "32270"
 "PRDARE", "CATPRA5", "SY(FLASTK01)", "34", "O", "OTHER", "32270"
 "PRDARE", "CATPRA6", "SY(TMBYRD01)", "34", "O", "OTHER", "32270"
 "PRDARE", "CATPRA8", "SY(TNKCON02)", "34", "O", "OTHER", "32270"
 "PRDARE", "CATPRA9", "SY(WIMCON01)", "34", "O", "OTHER", "32270"
 "PYLONS", "", "SY(POSGEN03)", "8", "O", "DISPLA YBASE", "12210"
 "RADRFL", "", "SY(RADRFL03)", "6", "O", "STANDARD", "27230"
 "RADSTA", "", "SY(POSGEN01)", "5", "O", "OTHER", "38010"
 "RADSTA", "CATRAS2", "SY(RDOSTA02);TE('ch %s', 'COMCHA', 3, 1, 2, '15110', 0, 0, CHBLK, 11)", "5", "O", "OTHER", "38010"
 "RAPIDS", "", "", "", "", "", ""
 "RCTLPT", "", "SY(RTLDEF51)", "4", "O", "STANDARD", "25020"
 "RCTLPT", "ORIENT", "SY(RCTLPT52, ORIENT)", "4", "O", "STANDARD", "25020"
 "RDOCAL", "", "SY(RCLDEF01);TE('Nr %s', 'OBJNAM', 3, 2, 2, '15110', 1, -1, CHBLK, 21)", "6", "O", "STANDARD", "25060"
 "RDOCAL", "TRAFIC1ORIENT", "SY(RDOCAL02, ORIENT);TE('Nr %s', 'OBJNAM', 3, 1, 2, '15110', 1, -1, CHBLK, 21);TE('ch %s', 'COMCHA', 3, 1, 2, '15110', 1, 1, CHBLK, 11)", "6", "O", "STANDARD", "25060"
 "RDOCAL", "TRAFIC2ORIENT", "SY(RDOCAL02, ORIENT);TE('Nr %s', 'OBJNAM', 3, 1, 2, '15110', 1, -1, CHBLK, 21);TE('ch %s', 'COMCHA', 3, 1, 2, '15110', 1, 1, CHBLK, 11)", "6", "O", "STANDARD", "25060"
 "RDOCAL", "TRAFIC3ORIENT", "SY(RDOCAL02, ORIENT);TE('Nr %s', 'OBJNAM', 3, 1, 2, '15110', 1, -1, CHBLK, 21);TE('ch %s', 'COMCHA', 3, 1, 2, '15110', 1, 1, CHBLK, 11)", "6", "O", "STANDARD", "25060"
 "RDOCAL", "TRAFIC4ORIENT", "SY(RDOCAL03, ORIENT);TE('Nr %s', 'OBJNAM', 3, 1, 2, '15110', 1, -1, CHBLK, 21);TE('ch %s', 'COMCHA', 3, 1, 2, '15110', 1, 1, CHBLK, 11)", "6", "O", "STANDARD", "25060"
 "RDOSTA", "", "SY(RDOSTA02)", "4", "O", "OTHER", "38010"
 "RDOSTA", "CATROS10", "SY(DGPS04, DRFSTA01)", "4", "O", "OTHER", "38010"
 "RETRFL", "", "SY(RETRFL01)", "6", "O", "STANDARD", "27080"
 "ROADWY", "", "", "", "", "", ""
 "RSCSTA", "", "SY(RSCSTA02)", "7", "O", "OTHER", "38030"
 "RTPBCN", "", "SY(RTPBCN02)", "6", "O", "STANDARD", "27210"
 "RUNWAY", "", "", "", "", "", ""
 "SBDARE", "", "TX(NATSUR, 1, 2, 2, '15110', 0, 0, CHBLK, 25)", "4", "O", "OTHER", "34010"
 "SEAARE", "", "TX(OBJNAM, 1, 2, 3, '15110', 0, 0, CHBLK, 26)", "3", "S", "STANDARD", "21060"
 "SILTNK", "", "SY(TNKCON02)", "4", "O", "OTHER", "32220"
 "SILTNK", "CATSIL1CONVIS1", "SY(SILBUI11)", "4", "O", "STANDARD", "22220"
 "SILTNK", "CATSIL2CONVIS1", "SY(TNKCON12)", "4", "O", "STANDARD", "22220"
 "SILTNK", "CATSIL3CONVIS1", "SY(TOWERS03)", "4", "O", "STANDARD", "22220"
 "SILTNK", "CATSIL4CONVIS1", "SY(TOWERS12)", "4", "O", "STANDARD", "22220"
 "SILTNK", "CONVIS1", "SY(TNKCON12)", "4", "O", "STANDARD", "22220"
 "SILTNK", "CATSIL1", "SY(SILBUI01)", "4", "O", "OTHER", "32220"
 "SILTNK", "CATSIL2", "SY(TNKCON02)", "4", "O", "OTHER", "32220"
 "SILTNK", "CATSIL3", "SY(TOWERS01)", "4", "O", "OTHER", "32220"
 "SILTNK", "CATSIL4", "SY(TOWERS02)", "4", "O", "OTHER", "32220"
 "SISTAT", "", "SY(SISTAT02)", "7", "O", "STANDARD", "28020"
 "SISTAW", "", "SY(SISTAT02)", "7", "O", "STANDARD", "28020"

* *** section two: NON-STANDARD CLASSES ***

* *** ***

*

*Note: category "DISPLAYBASE" should not be removed from the display.

*For non-standard classes, all category "MARINERS STANDARD" and "MARINERS OTHER"

*should be drawn when "STANDARD DISPLAY" is drawn, and thereafter may be re-assigned

*to the category of chosen by the mariner.

*

```
"cursor", "", "SY(CURSRA01)", "8", "O", "DISPLAYBASE", "11010"
"cursor", "cursty2", "SY(CURSRB01)", "8", "O", "MARINERS OTHER", "61040"
"dnglht", "", "SY(DNGHILIT)", "8", "O", "MARINERS STANDARD", "53010"
"events", "", "SY(EVENTS03);TX(OBJNAM,3,2,3,'15110',1,0,CHBLK,50)", "8", "O", "MARINERS STANDARD", "52410"
"marfea", "", "SY(CHINFO09);TX(OBJNAM,3,1,3,'15110',1,-1,CHBLK,50)", "8", "O", "MARINERS STANDARD", "53050"
"marnot", "", "SY(CHINFO09);TX(usrmrk,3,1,2,'15110',0,0,CHBLK,50)", "8", "O", "MARINERS STANDARD", "53040"
"marnot", "catnot1", "SY(CHINFO08);TX(usrmrk,3,1,2,'15110',0,0,CHBLK,50)", "8", "O", "MARINERS STANDARD", "53030"
"marnot", "catnot2", "SY(CHINFO09);TX(usrmrk,3,1,2,'15110',0,0,CHBLK,50)", "8", "O", "MARINERS STANDARD", "53040"
"mnufea", "", "SY(CHINFO10)", "5", "O", "MARINERS STANDARD", "55010"
"mnufea", "catnot1", "SY(CHINFO10)", "5", "O", "MARINERS STANDARD", "55010"
"mnufea", "catnot2", "SY(CHINFO11)", "5", "O", "MARINERS STANDARD", "55020"
"ownshp", "", "CS(OWNSHP02)", "9", "O", "DISPLAYBASE", "42010"
"plnpos", "", "SY(PLNPOS01);SY(PLNPOS02,ORIENT);TX(plndat,1,2,2,'15110',4,3,CHBLK,50);", "5", "O", "MARINERS STANDARD", "52030"
"positn", "", "SY(POSITN02);TX(loctim,1,1,2,'15110',0,-1,CHBLK,50)", "5", "O", "MARINERS OTHER", "62010"
"positn", "pfmeth1", "SY(POSITN02);TX('DR',2,3,2,'15110',-1,1,CHBLK,50);TX(loctim,1,1,2,'15110',0,-1,CHBLK,50)", "5", "O", "MARINERS OTHER", "62010"
"positn", "pfmeth2", "SY(POSITN02);TX('EP',2,3,2,'15110',-1,1,CHBLK,50);TX(loctim,1,1,2,'15110',0,-1,CHBLK,50)", "5", "O", "MARINERS OTHER", "62010"
"positn", "pfmeth3", "SY(POSITN02);TX('V',3,3,2,'15110',1,1,CHBLK,50);TX(loctim,1,1,2,'15110',0,-1,CHBLK,50)", "5", "O", "MARINERS OTHER", "62010"
"positn", "pfmeth4", "SY(POSITN02);TX('A',3,3,2,'15110',1,1,CHBLK,50);TX(loctim,1,1,2,'15110',0,-1,CHBLK,50)", "5", "O", "MARINERS OTHER", "62010"
"positn", "pfmeth5", "SY(POSITN02);TX('R',3,3,2,'15110',1,1,CHBLK,50);TX(loctim,1,1,2,'15110',0,-1,CHBLK,50)", "5", "O", "MARINERS OTHER", "62010"
"positn", "pfmeth6", "SY(POSITN02);TX('D',3,3,2,'15110',1,1,CHBLK,50);TX(loctim,1,1,2,'15110',0,-1,CHBLK,50)", "5", "O", "MARINERS OTHER", "62010"
"positn", "pfmeth7", "SY(POSITN02);TX('G',3,3,2,'15110',1,1,CHBLK,50);TX(loctim,1,1,2,'15110',0,-1,CHBLK,50)", "5", "O", "MARINERS OTHER", "62010"
"positn", "pfmeth8", "SY(POSITN02);TX('GI',3,3,2,'15110',1,1,CHBLK,50);TX(loctim,1,1,2,'15110',0,-1,CHBLK,50)", "5", "O", "MARINERS OTHER", "62010"
"positn", "pfmeth9", "SY(POSITN02);TX('L',3,3,2,'15110',1,1,CHBLK,50);TX(loctim,1,1,2,'15110',0,-1,CHBLK,50)", "5", "O", "MARINERS OTHER", "62010"
"positn", "pfmeth10", "SY(POSITN02);TX('M',3,3,2,'15110',1,1,CHBLK,50);TX(loctim,1,1,2,'15110',0,-1,CHBLK,50)", "5", "O", "MARINERS OTHER", "62010"
"positn", "pfmeth11", "SY(POSITN02);TX('O',3,3,2,'15110',1,1,CHBLK,50);TX(loctim,1,1,2,'15110',0,-1,CHBLK,50)", "5", "O", "MARINERS OTHER", "62010"
"positn", "pfmeth12", "SY(POSITN02);TX('T',3,3,2,'15110',1,1,CHBLK,50);TX(loctim,1,1,2,'15110',0,-1,CHBLK,50)", "5", "O", "MARINERS OTHER", "62010"
"positn", "pfmeth13", "SY(POSITN02);TX('dG',3,3,2,'15110',1,1,CHBLK,50);TX(loctim,1,1,2,'15110',0,-1,CHBLK,50)", "5", "O", "MARINERS OTHER", "62010"
"positn", "pfmeth14", "SY(POSITN02);TX('dGI',3,3,2,'15110',1,1,CHBLK,50);TX(loctim,1,1,2,'15110',0,-1,CHBLK,50)", "5", "O", "MARINERS OTHER", "62010"
"positn", "pfmeth15", "SY(POSITN02);TX('dO',3,3,2,'15110',1,1,CHBLK,50);TX(loctim,1,1,2,'15110',0,-1,CHBLK,50)", "5", "O", "MARINERS OTHER", "62010"
"refpnt", "", "SY(REFPNT02)", "7", "O", "MARINERS OTHER", "61050"
"tidcur", "", "SY(TIDCUR01,ORIENT);SY(TIDCUR03);TX(curstr,2,3,2,'15110',-1,2,CHBLK,50);TX(loctim,3,1,2,'15110',1,-2,CHBLK,50)", "7", "O", "MARINERS STANDARD", "53080"
"tidcur", "catcur1", "SY(TIDCUR01,ORIENT);SY(TIDCUR03);TX('P',2,3,2,'15110',-4,2,CHBLK,50);TX(curstr,2,3,2,'15110',-1,2,CHBLK,50);TX(loctim,3,1,2,'15110',1,-2,CHBLK,50)", "7", "O", "MARINERS STANDARD", "53080"
"tidcur", "catcur2", "SY(TIDCUR02,ORIENT);SY(TIDCUR03);TX('A',2,3,2,'15110',-4,2,CHBLK,50);TX(curstr,2,3,2,'15110',-1,2,CHBLK,50);TX(loctim,3,1,2,'15110',1,-2,CHBLK,50)", "7", "O", "MARINERS STANDARD", "53080"
"vessel", "", "CS(VESSEL02)", "9", "O", "MARINERS STANDARD", "54030"
"waypnt", "", "SY(WAYPNT01);TX(OBJNAM,3,1,3,'15110',1,-1,APLRT,50)", "8", "O", "DISPLAYBASE", "42210"
"waypnt", "select1", "SY(WAYPNT01);TX(OBJNAM,3,1,3,'15110',1,-1,CHBLK,50)", "8", "O", "DISPLAYBASE", "42210"
```

```
"waypnt","select2","SY(WAYPNT03);TX(OBJNAM,3,1,3,'15110',1,-1,APLRT,50)","8","O","MARINERS STANDARD","52210"
*
* ***                ***
* *** end of look-up table ***
* ***                ***
```

11.1.2 Look-up Table for simplified point symbolisation

```
* *** SIMPLIFIED POINTS                ***
* *** This is the look-up table for point symbolization. ***
* *** For edition 3.4 Preslib, dated January 2008  ****
*
* Each line contains minimum 6 fields:
* 1. field - code of the object class
* 2. field - attribute combination
* 3. field - symbolization instruction
* 4. field - display priority
* 5. field - radar
* 6. field - IMO display category
* 7. field - viewing group (optional)
*
* Each field entry is framed by "" and fields are separated by '!'.
*
* Please note, that the entries to this table must be in
* alphabetic order (sorted by the class code).
*
* This table has 2 sections:
*
* - The first section contains symbolization instructions for
* standard S-57 'real world' objects:
* - The second section contains symbolization instructions for
* non-standard (class code in lowercase) objects:
*
* default for symbolization failure; must be the first entry to look-up table
*#####",", "SY(QUESMRK1)", "5", "O", "STANDARD", "21010"
*
* ***                ***
* *** section one: REAL WORLD CLASSES ***
* ***                ***
```

"BOYSPP","BOYSH5","SY(BOYSPP35);TE('by %s','OBJNAM',2,1,2,'15110',-1,-1,CHBLK,21)","8","O","STANDARD","27010"
"BOYSPP","BOYSH6","SY(BOYSPP11);TE('by %s','OBJNAM',2,1,2,'15110',-1,-1,CHBLK,21)","8","O","STANDARD","27010"
"BOYSPP","BOYSH7","SY(BOYSUP02);TE('by %s','OBJNAM',2,1,2,'15110',-1,-1,CHBLK,21)","8","O","STANDARD","27010"
"BOYSPP","BOYSH8","SY(BOYSPP35);TE('by %s','OBJNAM',2,1,2,'15110',-1,-1,CHBLK,21)","8","O","STANDARD","27010"
"BRIDGE",,,,,,
"BUAARE",,,,,,"SY(BUAARE02);TX(OBJNAM,3,2,2,'15110',1,0,CHBLK,26)","3","O","STANDARD","22240"
"BUISGL",,,,,,"SY(BUISGL01)","4","O","OTHER","32220"
"BUISGL","FUNCTN33CONVIS1OBJNAM","SY(POSGEN03);TX(OBJNAM,3,2,2,'15110',1,0,CHBLK,26)","6","O","STANDARD","22220"
"BUISGL","FUNCTN20CONVIS1","SY(BUIREL13)","6","O","STANDARD","22220"
"BUISGL","FUNCTN21CONVIS1","SY(BUIREL13)","6","O","STANDARD","22220"
"BUISGL","FUNCTN22CONVIS1","SY(BUIREL14)","6","O","STANDARD","22220"
"BUISGL","FUNCTN23CONVIS1","SY(BUIREL14)","6","O","STANDARD","22220"
"BUISGL","FUNCTN24CONVIS1","SY(BUIREL14)","6","O","STANDARD","22220"
"BUISGL","FUNCTN25CONVIS1","SY(BUIREL14)","6","O","STANDARD","22220"
"BUISGL","FUNCTN26CONVIS1","SY(BUIREL15)","6","O","STANDARD","22220"
"BUISGL","FUNCTN27CONVIS1","SY(BUIREL15)","6","O","STANDARD","22220"
"BUISGL","FUNCTN33CONVIS1","SY(POSGEN03)","6","O","STANDARD","22220"
"BUISGL","FUNCTN35CONVIS1","SY(TNKCON12)","6","O","STANDARD","22220"
"BUISGL","FUNCTN33OBJNAM","SY(POSGEN03);TX(OBJNAM,3,2,2,'15110',1,0,CHBLK,26)","4","O","OTHER","32220"
"BUISGL","CONVIS1","SY(BUISGL11)","6","O","STANDARD","22220"
"BUISGL","FUNCTN20","SY(BUIREL01)","4","O","OTHER","32220"
"BUISGL","FUNCTN21","SY(BUIREL01)","4","O","OTHER","32220"
"BUISGL","FUNCTN22","SY(BUIREL04)","4","O","OTHER","32220"
"BUISGL","FUNCTN23","SY(BUIREL04)","4","O","OTHER","32220"
"BUISGL","FUNCTN24","SY(BUIREL04)","4","O","OTHER","32220"
"BUISGL","FUNCTN25","SY(BUIREL04)","4","O","OTHER","32220"
"BUISGL","FUNCTN26","SY(BUIREL05)","4","O","OTHER","32220"
"BUISGL","FUNCTN27","SY(BUIREL05)","4","O","OTHER","32220"
"BUISGL","FUNCTN33","SY(POSGEN03)","4","O","OTHER","32220"
"BUISGL","FUNCTN35","SY(TNKCON02)","4","O","OTHER","32220"
"CGUSTA",,,,,,"SY(CGUSTA02)","7","O","OTHER","38030"
"CHKPNT",,,,,,
"CHKPNT",,,,,,"SY(CHKPNT01)","4","S","OTHER","32410"
"CRANES",,,,,,"SY(CRANES01)","4","O","OTHER","32440"
"CTNARE",,,,,,"SY(CHINFO06)","4","O","STANDARD","26050"
"CTRPNT",,,,,,"SY(POSGEN04)","4","O","OTHER","32250"
"CTSARE",,,,,,"SY(CHINFO07)","4","O","STANDARD","26250"
"CURENT",,,,,,
"CURENT",,,,,,"SY(CURDEF01)","5","O","OTHER","33000"
"CURENT","ORIENTCURVEL","SY(CURENT01,ORIENT);TE('%4.1lf kn','CURVEL',3,1,2,'15110',1,-1,CHBLK,31)","5","O","OTHER","33060"
"CURENT","ORIENT","SY(CURENT01,ORIENT)","5","O","OTHER","33060"
"DAMCON",,,,,,
"DAMCON","CATDAM3","SY(CHINFO06)","4","O","STANDARD","22010"
"DAYMAR",,,,,,"SY(DAYSQR01);TE('bn %s','OBJNAM',2,1,2,'15110',-1,-1,CHBLK,21)","7","O","STANDARD","27025"
"DAYMAR","TOPSHP19","SY(DAYSQR01);TE('bn %s','OBJNAM',2,1,2,'15110',-1,-1,CHBLK,21)","7","O","STANDARD","27025"
"DAYMAR","TOPSHP20","SY(DAYSQR01);TE('bn %s','OBJNAM',2,1,2,'15110',-1,-1,CHBLK,21)","7","O","STANDARD","27025"
"DAYMAR","TOPSHP21","SY(DAYSQR01);TE('bn %s','OBJNAM',2,1,2,'15110',-1,-1,CHBLK,21)","7","O","STANDARD","27025"
"DAYMAR","TOPSHP24","SY(DAYTRI01);TE('bn %s','OBJNAM',2,1,2,'15110',-1,-1,CHBLK,21)","7","O","STANDARD","27025"
"DAYMAR","TOPSHP25","SY(DAYTRI05);TE('bn %s','OBJNAM',2,1,2,'15110',-1,-1,CHBLK,21)","7","O","STANDARD","27025"

"DISMAR", "", "SY(DISMAR03);TX(INFORM,2,1,2,'15110',2,0,CHBLK,21)", "7", "O", "OTHER", "32430"
"DISMAR", "CATDIS1", "SY(DISMAR04);TX(INFORM,2,1,2,'15110',2,0,CHBLK,21)", "7", "O", "OTHER", "32430"
"DMPGRD", "", "SY(CHINFO07)", "4", "O", "STANDARD", "26240"
"FOGSIG", "", "SY(FOGSIG01)", "6", "O", "STANDARD", "27080"
"FORSTC", "", "SY(FORSTC01)", "4", "O", "OTHER", "32220"
"FORSTC", "CONVIS1", "SY(FORSTC11)", "4", "O", "STANDARD", "22220"
"FSHFAC", "", "SY(FSHHAV01)", "4", "O", "OTHER", "34040"
"FSHFAC", "CATFIF1", "SY(FSHFAC03)", "4", "O", "OTHER", "34040"
"FSHFAC", "CATFIF2", "SY(FSHFAC02)", "4", "O", "OTHER", "34040"
"FSHFAC", "CATFIF3", "SY(FSHFAC02)", "4", "O", "OTHER", "34040"
"FSHFAC", "CATFIF4", "SY(FSHFAC02)", "4", "O", "OTHER", "34040"
"GATCON", "", "SY(GATCON04)", "8", "O", "STANDARD", "22010"
"GATCON", "CATGAT2", "SY(GATCON04)", "8", "O", "STANDARD", "22010"
"GATCON", "CATGAT3", "SY(GATCON04)", "8", "O", "OTHER", "32440"
"GATCON", "CATGAT4", "SY(GATCON03)", "8", "O", "OTHER", "32440"
"GRIDRN", "", "", "", "", "", ""
"GRIDRN", "", "SY(GRIDRN01)", "5", "S", "OTHER", "32460"
"HRBFAC", "", "SY(CHINFO07)", "4", "O", "OTHER", "32410"
"HRBFAC", "CATHAF1", "SY(ROLROL01)", "4", "O", "OTHER", "32410"
"HRBFAC", "CATHAF4", "SY(HRBFAC09)", "4", "O", "OTHER", "32410"
"HRBFAC", "CATHAF5", "SY(SMCFAC02)", "4", "O", "OTHER", "32410"
"HULKES", "", "SY(HULKES01)", "5", "O", "DISPLAYBASE", "12410"
"ICNARE", "", "SY(CHINFO07)", "4", "O", "STANDARD", "26250"
"LIGHTS", "", "CS(LIGHTS05)", "8", "O", "STANDARD", "27070"
"LITFLT", "", "SY(LITFLT02);TE('by %s', OBJNAM, 2, 1, 2, '15110', -1, -1, CHBLK, 21)", "8", "O", "STANDARD", "27010"
"LITVES", "", "SY(LITVES02);TE('Lit %s', OBJNAM, 2, 1, 2, '15110', -1, -1, CHBLK, 21)", "8", "O", "STANDARD", "27011"
"LNDARE", "", "SY(LNDARE01); TX(OBJNAM, 1, 2, 2, '15110', 0, 1, CHBLK, 26);CS(QUAPOS01)", "4", "O", "DISPLAYBASE", "12010"
"LNDELV", "", "SY(POSGEN04);TE('%3.0lf m', ELEVAT, 3, 2, 2, '15110', 1, 0, CHBLK, 28)", "4", "O", "OTHER", "32010"
"LNDMRK", "", "SY(POSGEN01)", "4", "O", "OTHER", "32220"
"LNDMRK", "CATLMK17FUNCTN33CONVIS1", "SY(TOWERS03);TX(OBJNAM, 3, 2, 2, '15110', 1, -1, CHBLK, 26)", "6", "O", "STANDARD", "22220"
"LNDMRK", "CATLMK15FUNCTN20CONVIS1", "SY(BUIREL13)", "6", "O", "STANDARD", "22220"
"LNDMRK", "CATLMK15FUNCTN21CONVIS1", "SY(BUIREL13)", "6", "O", "STANDARD", "22220"
"LNDMRK", "CATLMK17FUNCTN20CONVIS1", "SY(BUIREL13)", "6", "O", "STANDARD", "22220"
"LNDMRK", "CATLMK17FUNCTN21CONVIS1", "SY(BUIREL13)", "6", "O", "STANDARD", "22220"
"LNDMRK", "CATLMK20FUNCTN20CONVIS1", "SY(BUIREL13)", "6", "O", "STANDARD", "22220"
"LNDMRK", "CATLMK20FUNCTN21CONVIS1", "SY(BUIREL13)", "6", "O", "STANDARD", "22220"
"LNDMRK", "CATLMK20FUNCTN26CONVIS1", "SY(BUIREL15)", "6", "O", "STANDARD", "22220"
"LNDMRK", "CATLMK20FUNCTN27CONVIS1", "SY(BUIREL15)", "6", "O", "STANDARD", "22220"
"LNDMRK", "CATLMK17FUNCTN33", "SY(TOWERS01);TX(OBJNAM, 3, 2, 2, '15110', 1, -1, CHBLK, 26)", "4", "O", "OTHER", "32220"
"LNDMRK", "CATLMK1CONVIS1", "SY(CAIRNS11)", "6", "O", "STANDARD", "22220"
"LNDMRK", "CATLMK3CONVIS1", "SY(CHIMNY11)", "6", "O", "STANDARD", "22220"
"LNDMRK", "CATLMK4CONVIS1", "SY(DSHAER11)", "6", "O", "STANDARD", "22220"
"LNDMRK", "CATLMK5CONVIS1", "SY(FLGSTF01)", "6", "O", "STANDARD", "22220"
"LNDMRK", "CATLMK6CONVIS1", "SY(FLASTK11)", "6", "O", "STANDARD", "22220"
"LNDMRK", "CATLMK7CONVIS1", "SY(MSTCON14)", "6", "O", "STANDARD", "22220"
"LNDMRK", "CATLMK8CONVIS1", "SY(POSGEN03)", "6", "O", "STANDARD", "22220"
"LNDMRK", "CATLMK9CONVIS1", "SY(MONUMT12)", "6", "O", "STANDARD", "22220"
"LNDMRK", "CATLMK10CONVIS1", "SY(MONUMT12)", "6", "O", "STANDARD", "22220"
"LNDMRK", "CATLMK12CONVIS1", "SY(MONUMT12)", "6", "O", "STANDARD", "22220"

"LNDMRK","CATLMK13CONVIS1","SY(MONUMT12)","6","O","STANDARD","22220"
 "LNDMRK","CATLMK15CONVIS1","SY(DOMES011)","6","O","STANDARD","22220"
 "LNDMRK","CATLMK16CONVIS1","SY(RASCAN11)","6","O","STANDARD","22220"
 "LNDMRK","CATLMK17CONVIS1","SY(TOWERS03)","6","O","STANDARD","22220"
 "LNDMRK","CATLMK18CONVIS1","SY(WNDMIL12)","6","O","STANDARD","22220"
 "LNDMRK","CATLMK19CONVIS1","SY(WIMCON11)","6","O","STANDARD","22220"
 "LNDMRK","CATLMK20CONVIS1","SY(POSGEN03)","6","O","STANDARD","22220"
 "LNDMRK","CATLMK15FUNCTN20","SY(BUIREL01)","4","O","OTHER","32220"
 "LNDMRK","CATLMK17FUNCTN20","SY(BUIREL01)","4","O","OTHER","32220"
 "LNDMRK","CATLMK20FUNCTN20","SY(BUIREL01)","4","O","OTHER","32220"
 "LNDMRK","CATLMK3","SY(CHIMNY01)","4","O","OTHER","32220"
 "LNDMRK","CATLMK6","SY(FLASTK01)","4","O","OTHER","32220"
 "LNDMRK","CATLMK7","SY(MSTCON04)","4","O","OTHER","32220"
 "LNDMRK","CATLMK15","SY(DOMES001)","4","O","OTHER","32220"
 "LNDMRK","CATLMK16","SY(RASCAN01)","4","O","OTHER","32220"
 "LNDMRK","CATLMK17","SY(TOWERS01)","4","O","OTHER","32220"
 "LNDMRK","CONVIS1","SY(POSGEN03)","6","O","STANDARD","22220"
 "LNDRGN","","SY(POSGEN04);TX(OBJNAM,1,2,2,'15110',0,-1,CHBLK,26)","4","O","STANDARD","21060"
 "LOCMAG","","SY(LOCMAG01)","4","O","OTHER","31080"
 "LOGPON","","SY(FLTHAZ02)","4","O","OTHER","34050"
 "M_NPUB","","SY(CHINFO07)","4","O","OTHER","31020"
 "MAGVAR","","SY(MAGVAR01);TX(VALMAG,3,1,2,'15110',1,-1,CHBLK,27)","4","O","OTHER","31080"
 "MARCUL","","SY(MARCUL02)","4","O","STANDARD","26210"
 "MIPARE","","SY(CHINFO06)","4","O","STANDARD","26040"
 "MORFAC","","SY(MORFAC03)","6","O","DISPLAYBASE","12410"
 "MORFAC","CATMOR1","SY(MORFAC03)","6","O","DISPLAYBASE","12410"
 "MORFAC","CATMOR2","SY(MORFAC04)","6","O","DISPLAYBASE","12410"
 "MORFAC","CATMOR3","SY(PILPNT02)","6","O","OTHER","32440"
 "MORFAC","CATMOR5","SY(PILPNT02)","6","O","DISPLAYBASE","12410"
 "MORFAC","CATMOR7","SY(BOYMOR11)","8","O","STANDARD","27010"
 "NEWOBJ","","SY(NEWOBJ 01)","6","S","STANDARD","21020"
 "NEWOBJ","SYMINS","CS(SYMINS01)","6","S","STANDARD","21020"
 "OBSTRN","","CS(OBSTRN06)","4","O","OTHER","34050"
 "OBSTRN","CATOBS7VALSOU","SY(FOULGND1)","4","O","OTHER","34051"
 "OBSTRN","CATOBS8VALSOU","SY(FLTHAZ02)","4","O","OTHER","34051"
 "OBSTRN","CATOBS9VALSOU","SY(ACHARE02)","4","O","OTHER","34051"
 "OBSTRN","CATOBS10VALSOU","SY(FLTHAZ02)","4","O","OTHER","34051"
 "OBSTRN","CATOBS7","SY(FOULGND1)","4","O","OTHER","34050"
 "OBSTRN","CATOBS8","SY(FLTHAZ02)","4","O","OTHER","34050"
 "OBSTRN","CATOBS9","SY(ACHARE02)","4","O","OTHER","34050"
 "OBSTRN","CATOBS10","SY(FLTHAZ02)","4","O","OTHER","34050"
 "OBSTRN","WATLEV7","SY(FLTHAZ02)","4","O","DISPLAYBASE","12410"
 "OFSPLF","","SY(OFSPLF01);TE('Prod %s',OBJNAM,3,1,2,'15110',1,-1,CHBLK,21)","5","O","DISPLAYBASE","12210"
 "PILBOP","","SY(PILBOP02);TE('Plt %s',OBJNAM,3,1,2,'15110',1,-1,CHBLK,21)","6","O","STANDARD","28010"
 "PILPNT","","SY(PILPNT02)","5","O","DISPLAYBASE","12410"
 "PIPARE","","SY(CHINFO07)","4","O","STANDARD","26230"
 "PIPSOL","","SY(CHINFO07)","4","O","STANDARD","26230"
 "PRCARE","","SY(PRCARE 12)","5","O","STANDARD","25010"
 "PRDARE","","SY(PRCARE 12)","5","O","STANDARD","25010"

"PRDARE","CATPRA5CONVIS1","SY(FLASTK11)","4","O","STANDARD","22220"
 "PRDARE","CATPRA8CONVIS1","SY(TNKCON12)","4","O","STANDARD","22220"
 "PRDARE","CATPRA9CONVIS1","SY(WIMCON11)","4","O","STANDARD","22220"
 "PRDARE","CATPRA1","SY(PRDINS02)","34","O","OTHER","32270"
 "PRDARE","CATPRA5","SY(FLASTK01)","34","O","OTHER","32270"
 "PRDARE","CATPRA6","SY(TMBYRD01)","34","O","OTHER","32270"
 "PRDARE","CATPRA8","SY(TNKCON02)","34","O","OTHER","32270"
 "PRDARE","CATPRA9","SY(WIMCON01)","34","O","OTHER","32270"
 "PYLONS","SY(POSGEN03)","8","O","DISPLAYBASE","12210"
 "RADRFL","SY(RADRFL03)","6","O","STANDARD","27230"
 "RADSTA","SY(POSGEN01)","5","O","OTHER","38010"
 "RADSTA","CATRAS2","SY(RDOSTA02);TE('ch %s','COMCHA',3,1,2,'15110',0,0,CHBLK,11)");5","O","OTHER","38010"
 "RAPIDS","SY(RTLDEF51)","4","O","STANDARD","25020"
 "RCTLPT","ORIENT","SY(RCTLPT52,ORIENT)","4","O","STANDARD","25020"
 "RDOCAL","SY(RCLDEF01);TE('Nr %s','OBJNAM',3,2,2,'15110',1,-1,CHBLK,21)");6","O","STANDARD","25060"
 "RDOCAL","TRAFIC1ORIENT","SY(RDOCAL02,ORIENT);TE('Nr %s','OBJNAM',3,1,2,'15110',1,-1,CHBLK,21);TE('ch %s','COMCHA',3,1,2,'15110',1,1,CHBLK,11)");6","O","STANDARD","25060"
 "RDOCAL","TRAFIC2ORIENT","SY(RDOCAL02,ORIENT);TE('Nr %s','OBJNAM',3,1,2,'15110',1,-1,CHBLK,21);TE('ch %s','COMCHA',3,1,2,'15110',1,1,CHBLK,11)");6","O","STANDARD","25060"
 "RDOCAL","TRAFIC3ORIENT","SY(RDOCAL02,ORIENT);TE('Nr %s','OBJNAM',3,1,2,'15110',1,-1,CHBLK,21);TE('ch %s','COMCHA',3,1,2,'15110',1,1,CHBLK,11)");6","O","STANDARD","25060"
 "RDOCAL","TRAFIC4ORIENT","SY(RDOCAL03,ORIENT);TE('Nr %s','OBJNAM',3,1,2,'15110',1,-1,CHBLK,21);TE('ch %s','COMCHA',3,1,2,'15110',1,1,CHBLK,11)");6","O","STANDARD","25060"
 "RDOSTA","SY(RDOSTA02)","4","O","OTHER","38010"
 "RDOSTA","CATROS10","SY(DGPS04DRFSTA01)","4","O","OTHER","38010"
 "RETRFL","SY(RETRFL02)","6","O","STANDARD","27080"
 "ROADWY","SY(RSCSTA02)","7","O","OTHER","38030"
 "RTPBCN","SY(RTPBCN02)","6","O","STANDARD","27210"
 "RUNWAY","TX(NATSUR,1,2,2,'15110',0,0,CHBLK,25)");4","O","OTHER","34010"
 "SEAARE","TX(OBJNAM,1,2,3,'15110',0,0,CHBLK,26)");3","S","STANDARD","21060"
 "SILTNK","SY(TNKCON02)","4","O","OTHER","32220"
 "SILTNK","CATSIL1CONVIS1","SY(SILBUI11)","4","O","STANDARD","22220"
 "SILTNK","CATSIL2CONVIS1","SY(TNKCON12)","4","O","STANDARD","22220"
 "SILTNK","CATSIL3CONVIS1","SY(TOWERS03)","4","O","STANDARD","22220"
 "SILTNK","CATSIL4CONVIS1","SY(TOWERS12)","4","O","STANDARD","22220"
 "SILTNK","CONVIS1","SY(TNKCON12)","4","O","STANDARD","22220"
 "SILTNK","CATSIL1","SY(SILBUI01)","4","O","OTHER","32220"
 "SILTNK","CATSIL2","SY(TNKCON02)","4","O","OTHER","32220"
 "SILTNK","CATSIL3","SY(TOWERS01)","4","O","OTHER","32220"
 "SILTNK","CATSIL4","SY(TOWERS02)","4","O","OTHER","32220"
 "SISTAT","SY(SISTAT02)","7","O","STANDARD","28020"
 "SISTAW","SY(SISTAT02)","7","O","STANDARD","28020"
 "SLCONS","SY(MORFAC03);CS(SLCONS03)");8","O","DISPLAYBASE","12410"
 "SLOGRD","SY(HILTOP01)","3","S","OTHER","32010"
 "SLOTOP","SY(HILTOP01)","3","S","OTHER","32010"
 "SLOTOP","CONVIS1","SY(HILTOP11)");3","S","STANDARD","22220"

```

"SMCFAC",,,,,,"
"SMCFAC",,,,,,"SY(SMCFAC02)",4,"S","OTHER",38210"
"SNDWAV",,,,,,"SY(SNDWAV02)",4,"O","STANDARD",24010"
"SOUNDG",,,,,,"CS(SOUNDG02)",6,"O","OTHER",33010"
"SPLARE",,,,,,"SY(CHINFO06)",4,"O","STANDARD",26040"
"SPRING",,,,,,"SY(SPRING02)",4,"O","OTHER",34020"
"T_HMON",,,,,,"SY(TIDEHT01)",4,"O","OTHER",33050"
"T_NHMN",,,,,,"SY(TIDEHT01)",4,"O","OTHER",33050"
"T_TIMS",,,,,,"SY(TIDEHT01)",4,"O","OTHER",33050"
"TS_FEB",,,,,,"SY(CURDEF01)",4,"O","OTHER",33060"
"TS_FEB",,,,,,"CAT_TS1ORIENT",SY(FLDSTR01,ORIENT);TE(%4.1f kn',CURVEL',3,1,2,'15110',1,-1,CHBLK,31)",4,"O","OTHER",33060"
"TS_FEB",,,,,,"CAT_TS2ORIENT",SY(EBBSTR01,ORIENT);TE(%4.1f kn',CURVEL',3,1,2,'15110',1,-1,CHBLK,31)",4,"O","OTHER",33060"
"TS_FEB",,,,,,"CAT_TS3ORIENT",SY(CURRENT01,ORIENT);TE(%4.1f kn',CURVEL',3,1,2,'15110',1,-1,CHBLK,31)",4,"O","OTHER",33060"
"TS_PAD",,,,,,"SY(TIDSTR01)",4,"O","OTHER",33060"
"TS_PNH",,,,,,"SY(TIDSTR01)",4,"O","OTHER",33060"
"TS_PRH",,,,,,"SY(TIDSTR01)",4,"O","OTHER",33060"
"TS_TIS",,,,,,"SY(TIDSTR01)",4,"O","OTHER",33060"
"TOPMAR",,,,,,"
"TUNNEL",,,,,,"
"UWTRC",,,,,,"CS(OBSTRN06)",4,"O","OTHER",34050"
"VEGATN",,,,,,"
"VEGATN",,,,,,"CATVEG7",SY(TREPNT05)",3,"S","OTHER",32030"
"VEGATN",,,,,,"CATVEG21",SY(TREPNT05)",3,"S","OTHER",32030"
"VEGATN",,,,,,"CATVEG3",SY(TREPNT04)",3,"S","OTHER",32030"
"VEGATN",,,,,,"CATVEG4",SY(TREPNT04)",3,"S","OTHER",32030"
"VEGATN",,,,,,"CATVEG5",SY(TREPNT04)",3,"S","OTHER",32030"
"VEGATN",,,,,,"CATVEG6",SY(TREPNT04)",3,"S","OTHER",32030"
"VEGATN",,,,,,"CATVEG13",SY(TREPNT04)",3,"S","OTHER",32030"
"VEGATN",,,,,,"CATVEG14",SY(TREPNT04)",3,"S","OTHER",32030"
"VEGATN",,,,,,"CATVEG15",SY(TREPNT04)",3,"S","OTHER",32030"
"VEGATN",,,,,,"CATVEG16",SY(TREPNT04)",3,"S","OTHER",32030"
"VEGATN",,,,,,"CATVEG17",SY(TREPNT04)",3,"S","OTHER",32030"
"VEGATN",,,,,,"CATVEG18",SY(TREPNT04)",3,"S","OTHER",32030"
"VEGATN",,,,,,"CATVEG19",SY(TREPNT04)",3,"S","OTHER",32030"
"VEGATN",,,,,,"CATVEG20",SY(TREPNT04)",3,"S","OTHER",32030"
"VEGATN",,,,,,"CATVEG22",SY(TREPNT04)",3,"S","OTHER",32030"
"WATFAL",,,,,,"
"WATTUR",,,,,,"SY(WATTUR02)",3,"O","OTHER",33040"
"WEDKLP",,,,,,"SY(WEDKLP03)",3,"O","OTHER",34020"
"WRECKS",,,,,,"CS(WRECKS04)",4,"O","OTHER",34050"
"WRECKS",,,,,,"CATWRK3VALSOU",SY(FOULGND1)",4,"O","OTHER",34051"
"WRECKS",,,,,,"CATWRK3",SY(FOULGND1)",4,"O","OTHER",34050"
*
* ***
* *** section two: NON-STANDARD CLASSES ***
* ***
*

```

*Note: category "DISPLAYBASE" should not be removed from the display.
 *For non-standard classes, all category "MARINERS STANDARD" and "MARINERS OTHER"
 *should be drawn when "STANDARD DISPLAY" is drawn, and thereafter may be re-assigned
 *to the category of chosen by the mariner.

*

```
"cursor", "", "SY(CURSRA01)", "8", "O", "DISPLAYBASE", "11010"
"cursor", "cursty2", "SY(CURSRB01)", "8", "O", "MARINERS OTHER", "61040"
"dnglht", "", "SY(DNGHILIT)", "8", "O", "MARINERS STANDARD", "53010"
"events", "", "SY(EVENTS03);TX(OBJNAM,3,2,3,'15110',1,0,CHBLK,50)", "8", "O", "MARINERS STANDARD", "52410"
"marfea", "", "SY(CHINFO09);TX(OBJNAM,3,1,3,'15110',1,-1,CHBLK,50)", "8", "O", "MARINERS STANDARD", "53050"
"marnot", "", "SY(CHINFO09);TX(usrmrk,3,1,2,'15110',0,0,CHBLK,50)", "8", "O", "MARINERS STANDARD", "53040"
"marnot", "catnot1", "SY(CHINFO08);TX(usrmrk,3,1,2,'15110',0,0,CHBLK,50)", "8", "O", "MARINERS STANDARD", "53030"
"marnot", "catnot2", "SY(CHINFO09);TX(usrmrk,3,1,2,'15110',0,0,CHBLK,50)", "8", "O", "MARINERS STANDARD", "53040"
"mnufea", "", "SY(CHINFO10)", "5", "O", "MARINERS STANDARD", "55010"
"mnufea", "catnot1", "SY(CHINFO10)", "5", "O", "MARINERS STANDARD", "55010"
"mnufea", "catnot2", "SY(CHINFO11)", "5", "O", "MARINERS STANDARD", "55020"
"ownshp", "", "CS(OWNSHP02)", "9", "O", "DISPLAYBASE", "42010"
"plnpos", "", "SY(PLNPOS01);SY(PLNPOS02,ORIENT);TX(plndat,1,2,2,'15110',4,3,CHBLK,50);", "5", "O", "MARINERS STANDARD", "52030"
"positn", "", "SY(POSITN02);TX(loctim,1,1,2,'15110',0,-1,CHBLK,50)", "5", "O", "MARINERS OTHER", "62010"
"positn", "pfmeth1", "SY(POSITN02);TX('DR',2,3,2,'15110',-1,1,CHBLK,50);TX(loctim,1,1,2,'15110',0,-1,CHBLK,50)", "5", "O", "MARINERS OTHER", "62010"
"positn", "pfmeth2", "SY(POSITN02);TX('EP',2,3,2,'15110',-1,1,CHBLK,50);TX(loctim,1,1,2,'15110',0,-1,CHBLK,50)", "5", "O", "MARINERS OTHER", "62010"
"positn", "pfmeth3", "SY(POSITN02);TX('V',3,3,2,'15110',1,1,CHBLK,50);TX(loctim,1,1,2,'15110',0,-1,CHBLK,50)", "5", "O", "MARINERS OTHER", "62010"
"positn", "pfmeth4", "SY(POSITN02);TX('A',3,3,2,'15110',1,1,CHBLK,50);TX(loctim,1,1,2,'15110',0,-1,CHBLK,50)", "5", "O", "MARINERS OTHER", "62010"
"positn", "pfmeth5", "SY(POSITN02);TX('R',3,3,2,'15110',1,1,CHBLK,50);TX(loctim,1,1,2,'15110',0,-1,CHBLK,50)", "5", "O", "MARINERS OTHER", "62010"
"positn", "pfmeth6", "SY(POSITN02);TX('D',3,3,2,'15110',1,1,CHBLK,50);TX(loctim,1,1,2,'15110',0,-1,CHBLK,50)", "5", "O", "MARINERS OTHER", "62010"
"positn", "pfmeth7", "SY(POSITN02);TX('G',3,3,2,'15110',1,1,CHBLK,50);TX(loctim,1,1,2,'15110',0,-1,CHBLK,50)", "5", "O", "MARINERS OTHER", "62010"
"positn", "pfmeth8", "SY(POSITN02);TX('GI',3,3,2,'15110',1,1,CHBLK,50);TX(loctim,1,1,2,'15110',0,-1,CHBLK,50)", "5", "O", "MARINERS OTHER", "62010"
"positn", "pfmeth9", "SY(POSITN02);TX('L',3,3,2,'15110',1,1,CHBLK,50);TX(loctim,1,1,2,'15110',0,-1,CHBLK,50)", "5", "O", "MARINERS OTHER", "62010"
"positn", "pfmeth10", "SY(POSITN02);TX('M',3,3,2,'15110',1,1,CHBLK,50);TX(loctim,1,1,2,'15110',0,-1,CHBLK,50)", "5", "O", "MARINERS OTHER", "62010"
"positn", "pfmeth11", "SY(POSITN02);TX('O',3,3,2,'15110',1,1,CHBLK,50);TX(loctim,1,1,2,'15110',0,-1,CHBLK,50)", "5", "O", "MARINERS OTHER", "62010"
"positn", "pfmeth12", "SY(POSITN02);TX('T',3,3,2,'15110',1,1,CHBLK,50);TX(loctim,1,1,2,'15110',0,-1,CHBLK,50)", "5", "O", "MARINERS OTHER", "62010"
"positn", "pfmeth13", "SY(POSITN02);TX('dG',3,3,2,'15110',1,1,CHBLK,50);TX(loctim,1,1,2,'15110',0,-1,CHBLK,50)", "5", "O", "MARINERS OTHER", "62010"
"positn", "pfmeth14", "SY(POSITN02);TX('dGI',3,3,2,'15110',1,1,CHBLK,50);TX(loctim,1,1,2,'15110',0,-1,CHBLK,50)", "5", "O", "MARINERS OTHER", "62010"
"positn", "pfmeth15", "SY(POSITN02);TX('dO',3,3,2,'15110',1,1,CHBLK,50);TX(loctim,1,1,2,'15110',0,-1,CHBLK,50)", "5", "O", "MARINERS OTHER", "62010"
"refpnt", "", "SY(REFPNT02)", "7", "O", "MARINERS OTHER", "61050"
"tidcur", "", "SY(TIDCUR01,ORIENT);SY(TIDCUR03);TX(curstr,2,3,2,'15110',-1,2,CHBLK,50);TX(loctim,3,1,2,'15110',1,-2,CHBLK,50)", "7", "O", "MARINERS STANDARD", "53080"
"tidcur", "catcur1", "SY(TIDCUR01,ORIENT);SY(TIDCUR03);TX('P',2,3,2,'15110',-4,2,CHBLK,50);TX(curstr,2,3,2,'15110',-1,2,CHBLK,50);TX(loctim,3,1,2,'15110',1,-2,CHBLK,50)", "7", "O", "MARINERS STANDARD", "53080"
"tidcur", "catcur2", "SY(TIDCUR02,ORIENT);SY(TIDCUR03);TX('A',2,3,2,'15110',-4,2,CHBLK,50);TX(curstr,2,3,2,'15110',-1,2,CHBLK,50);TX(loctim,3,1,2,'15110',1,-2,CHBLK,50)", "7", "O", "MARINERS STANDARD", "53080"
"vessel", "", "CS(VESSEL02)", "9", "O", "MARINERS STANDARD", "54030"
"waypnt", "", "SY(WAYPNT01);TX(OBJNAM,3,1,3,'15110',1,-1,APLRT,50)", "8", "O", "DISPLAYBASE", "42210"
"waypnt", "select1", "SY(WAYPNT01);TX(OBJNAM,3,1,3,'15110',1,-1,CHBLK,50)", "8", "O", "DISPLAYBASE", "42210"
"waypnt", "select2", "SY(WAYPNT03);TX(OBJNAM,3,1,3,'15110',1,-1,APLRT,50)", "8", "O", "MARINERS STANDARD", "52210"
```

*

*** ***

* *** end of look-up table ***
 * ***

11.2 Look-up Table Listing for Object Type Line 'L'

* *** LINES ***
 * *** This is the look-up table for line symbolization. ***
 * *** For edition 3.4 Preslib, dated January 2008 *****
 *

* Each line contains minimum 6 fields:

- * 1. field - code of the object class
- * 2. field - attribute combination
- * 3. field - symbolization instruction
- * 4. field - display priority
- * 5. field - radar
- * 6. field - IMO display category
- * 7. field - viewing group (optional)

*

* Each field entry is framed by "" and fields are separated by ','.

*

* Please note, that the entries to this table must be in
 * alphabetic order (sorted by the class code).

*

* This table has 2 sections:

*

- * - The first section contains symbolization instructions for
 * standard S-57 'real world' objects:
- * - The second section contains symbolization instructions for
 * non-standard (class code in lowercase) objects:

*

* default for symbolization failure; must be the first entry to look-up table

"#####", "", "LC(QUESMRK1)", "5", "O", "STANDARD", "21010"

*

* ***
 * *** section one: REAL WORLD CLASSES ***
 * ***

*

"ASLXIS", "", "LS(DASH,2,CHMGF)", "5", "S", "STANDARD", "26260"
 "BERTHS", "", "LS(SOLD,3,CHGRD);SY(BRTHNO01);TE('Nr %s','OBJNAM',1,2,2,'15110',0,0,CHBLK,29)", "5", "O", "OTHER", "32440"
 "BRIDGE", "", "LS(SOLD,5,CHGRD);TX(OBJNAM,3,1,2,'15110',1,0,CHBLK,21);TE('clr %4.1f','VERCLR',3,1,2,'15110',1,1,CHBLK,11)", "8", "O", "DISPLAYBASE", "12210"

"BRIDGE","CATBRG2","LS(SOLD,5,CHGRD);SY(BRIDGE01);TE('clr cl %4.1lf','VERCCL',3,1,2,'15110',1,0,CHBLK,11);TE('clr op %4.1lf','VERCOP',3,1,2,'15110',1,1,CHBLK,11)","8","O","DISPLAYBASE","12210"

"BRIDGE","CATBRG3","LS(SOLD,5,CHGRD);SY(BRIDGE01);TE('clr cl %4.1lf','VERCCL',3,1,2,'15110',1,0,CHBLK,11);TE('clr op %4.1lf','VERCOP',3,1,2,'15110',1,1,CHBLK,11)","8","O","DISPLAYBASE","12210"

"BRIDGE","CATBRG4","LS(SOLD,5,CHGRD);SY(BRIDGE01);TE('clr cl %4.1lf','VERCCL',3,1,2,'15110',1,0,CHBLK,11);TE('clr op %4.1lf','VERCOP',3,1,2,'15110',1,1,CHBLK,11)","8","O","DISPLAYBASE","12210"

"BRIDGE","CATBRG5","LS(SOLD,5,CHGRD);SY(BRIDGE01);TE('clr cl %4.1lf','VERCCL',3,1,2,'15110',1,0,CHBLK,11);TE('clr op %4.1lf','VERCOP',3,1,2,'15110',1,1,CHBLK,11)","8","O","DISPLAYBASE","12210"

"BRIDGE","CATBRG7","LS(SOLD,5,CHGRD);SY(BRIDGE01);TE('clr cl %4.1lf','VERCCL',3,1,2,'15110',1,0,CHBLK,11);TE('clr op %4.1lf','VERCOP',3,1,2,'15110',1,1,CHBLK,11)","8","O","DISPLAYBASE","12210"

"BRIDGE","CATBRG8","LS(SOLD,5,CHGRD);SY(BRIDGE01);TE('clr cl %4.1lf','VERCCL',3,1,2,'15110',1,0,CHBLK,11);TE('clr op %4.1lf','VERCOP',3,1,2,'15110',1,1,CHBLK,11)","8","O","DISPLAYBASE","12210"

"CANALS","","LS(SOLD,1,CHBLK)","2","O","DISPLAYBASE","12420"

"CAUSWY","","LS(SOLD,3,LANDF)","5","O","STANDARD","22010"

"CAUSWY","WATLEV4","LS(DASH,3,LANDF)","5","O","STANDARD","22010"

"CBLOHD","","LS(DASH,4,CHGRD)","8","O","DISPLAYBASE","12210"

"CBLOHD","CONRAD1VERCSA","LS(DASH,4,CHGRD);SY(RACNSP01);TE('sf clr %4.1lf','VERCSA',3,1,2,'15110',1,0,CHBLK,11)","8","O","DISPLAYBASE","12210"

"CBLOHD","CONRAD3VERCSA","LS(DASH,4,CHGRD);SY(RACNSP01);TE('sf clr %4.1lf','VERCSA',3,1,2,'15110',1,0,CHBLK,11)","8","O","DISPLAYBASE","12210"

"CBLOHD","CONRAD1VERCLR","LS(DASH,4,CHGRD);SY(RACNSP01);TE('clr %4.1lf','VERCLR',3,1,2,'15110',1,0,CHBLK,11)","8","O","DISPLAYBASE","12210"

"CBLOHD","CONRAD3VERCLR","LS(DASH,4,CHGRD);SY(RACNSP01);TE('clr %4.1lf','VERCLR',3,1,2,'15110',1,0,CHBLK,11)","8","O","DISPLAYBASE","12210"

"CBLOHD","CONRAD1","LS(DASH,4,CHGRD);SY(RACNSP01)","8","O","DISPLAYBASE","12210"

"CBLOHD","CONRAD3","LS(DASH,4,CHGRD);SY(RACNSP01)","8","O","DISPLAYBASE","12210"

"CBLOHD","VERCSA","LS(DASH,4,CHGRD);TE('sf clr %4.1lf','VERCSA',3,1,2,'15110',1,0,CHBLK,11)","8","O","DISPLAYBASE","12210"

"CBLOHD","VERCLR","LS(DASH,4,CHGRD);TE('clr %4.1lf','VERCLR',3,1,2,'15110',1,0,CHBLK,11)","8","O","DISPLAYBASE","12210"

"CBLSUB","","LC(CBLSUB06)","3","O","OTHER","34070"

"CBLSUB","CATCBL6","LS(DASH,1,CHMGD)","6","O","STANDARD","24010"

"COALNE","","CS(QUAPOS01)","7","O","DISPLAYBASE","12410"

"COALNE","CATCOA6","LS(DASH,1,CSTLN)","7","O","DISPLAYBASE","12410"

"COALNE","CATCOA7","LS(DASH,1,CSTLN)","7","O","DISPLAYBASE","12410"

"COALNE","CATCOA8","LS(DASH,1,CSTLN)","7","O","DISPLAYBASE","12410"

"COALNE","CATCOA10","LS(DASH,1,CSTLN)","7","O","DISPLAYBASE","12410"

"CONVYR","","LS(DASH,4,CHGRD);TE('clr %4.1lf','VERCLR',3,1,2,'15110',1,0,CHBLK,11)","8","O","DISPLAYBASE","12210"

"CONVYR","CATCON1CONRAD1","LS(DASH,4,CHGRD);SY(RACNSP01);TE('clr %4.1lf','VERCLR',3,1,2,'15110',1,0,CHBLK,11)","8","O","DISPLAYBASE","12210"

"CONVYR","CATCON1CONRAD3","LS(DASH,4,CHGRD);SY(RACNSP01);TE('clr %4.1lf','VERCLR',3,1,2,'15110',1,0,CHBLK,11)","8","O","DISPLAYBASE","12210"

"CONVYR","CATCON2CONRAD1","LS(SOLD,3,CHGRD);SY(RACNSP01);TE('clr %4.1lf','VERCLR',3,1,2,'15110',1,0,CHBLK,11)","8","O","DISPLAYBASE","12210"

"CONVYR","CATCON2CONRAD3","LS(SOLD,3,CHGRD);SY(RACNSP01);TE('clr %4.1lf','VERCLR',3,1,2,'15110',1,0,CHBLK,11)","8","O","DISPLAYBASE","12210"

"CONVYR","CATCON1","LS(DASH,4,CHGRD);TE('clr %4.1lf','VERCLR',3,1,2,'15110',1,0,CHBLK,11)","8","O","DISPLAYBASE","12210"

"CONVYR","CATCON2","LS(SOLD,3,CHGRD);TE('clr %4.1lf','VERCLR',3,1,2,'15110',1,0,CHBLK,11)","8","O","DISPLAYBASE","12210"

"CONVYR","CONRAD1","LS(DASH,4,CHGRD);SY(RACNSP01);TE('clr %4.1lf','VERCLR',3,1,2,'15110',1,0,CHBLK,11)","8","O","DISPLAYBASE","12210"

"CONVYR","CONRAD3","LS(DASH,4,CHGRD);SY(RACNSP01);TE('clr %4.1lf','VERCLR',3,1,2,'15110',1,0,CHBLK,11)","8","O","DISPLAYBASE","12210"

"DAMCON","","LS(SOLD,4,LANDF)","6","O","STANDARD","22010"

"DAMCON","CATDAM3","LS(SOLD,2,CSTLN)","6","O","DISPLAYBASE","12410"

"DEPARE","","","",""

"DEPCNT","","CS(DEPCNT03)","5","O","OTHER","33020"

"DWRTCL","","LC(DWLDEF01);TE('%03.0lf deg','ORIENT',1,1,2,'15110',0,-1,CHBLK,11)","6","O","STANDARD","25010"

"DWRTCL","CATTRK1TRAFIC1","LC(DWRTCL08);TE('%03.0lf deg','ORIENT',1,1,2,'15110',0,-1,CHBLK,11)","6","O","STANDARD","25010"

"DWRTCL","CATTRK1TRAFIC2","LC(DWRTCL08);TE('%03.0lf deg','ORIENT',1,1,2,'15110',0,-1,CHBLK,11)","6","O","STANDARD","25010"

"DWRTCL","CATTRK1TRAFIC3","LC(DWRTCL08);TE('%03.0lf deg','ORIENT',1,1,2,'15110',0,-1,CHBLK,11)","6","O","STANDARD","25010"

"DWRTCL","CATTRK1TRAFIC4","LC(DWRTCL06);TE('%03.0lf deg','ORIENT',1,1,2,'15110',0,-1,CHBLK,11)","6","O","STANDARD","25010"

"DWRTCL","CATTRK2TRAFIC1","LC(DWRTCL07);TE(%03.0lf deg,'ORIENT',1,1,2,'15110',0,-1,CHBLK,11)","6","O","STANDARD","25010"
 "DWRTCL","CATTRK2TRAFIC2","LC(DWRTCL07);TE(%03.0lf deg,'ORIENT',1,1,2,'15110',0,-1,CHBLK,11)","6","O","STANDARD","25010"
 "DWRTCL","CATTRK2TRAFIC3","LC(DWRTCL07);TE(%03.0lf deg,'ORIENT',1,1,2,'15110',0,-1,CHBLK,11)","6","O","STANDARD","25010"
 "DWRTCL","CATTRK2TRAFIC4","LC(DWRTCL05);TE(%03.0lf deg,'ORIENT',1,1,2,'15110',0,-1,CHBLK,11)","6","O","STANDARD","25010"
 "DWRTCL","TRAFIC1","LC(DWRTCL07);TE(%03.0lf deg,'ORIENT',1,1,2,'15110',0,-1,CHBLK,11)","6","O","STANDARD","25010"
 "DWRTCL","TRAFIC2","LC(DWRTCL07);TE(%03.0lf deg,'ORIENT',1,1,2,'15110',0,-1,CHBLK,11)","6","O","STANDARD","25010"
 "DWRTCL","TRAFIC3","LC(DWRTCL07);TE(%03.0lf deg,'ORIENT',1,1,2,'15110',0,-1,CHBLK,11)","6","O","STANDARD","25010"
 "DWRTCL","TRAFIC4","LC(DWRTCL05);TE(%03.0lf deg,'ORIENT',1,1,2,'15110',0,-1,CHBLK,11)","6","O","STANDARD","25010"
 "DYKCON","","LS(SOLD,3,LANDF)","4","O","STANDARD","22010"
 "DYKCON","CONRAD1","LS(SOLD,2,CHBLK)","4","O","STANDARD","22210"
 "FERYRT","","LC(FERYRT02)","4","O","STANDARD","25030"
 "FERYRT","CATFRY1","LC(FERYRT01)","4","O","STANDARD","25030"
 "FERYRT","CATFRY2","LC(FERYRT02)","4","O","STANDARD","25030"
 "FLODOC","","LS(SOLD,3,CSTLN)","5","O","DISPLAYBASE","12410"
 "FNCLNE","","LS(SOLD,1,LANDF)","3","O","OTHER","32220"
 "FNCLNE","CONVIS1","LS(SOLD,1,CHBLK)","3","O","STANDARD","22220"
 "FORSTC","","LS(SOLD,3,LANDF)","4","O","OTHER","32220"
 "FSHFAC","","LS(DASH,2,CHGRD)","4","O","OTHER","34040"
 "FSHFAC","CATFIF1","LC(FSHFAC02)","4","O","OTHER","34040"
 "GATCON","","LS(SOLD,2,CSTLN)","8","O","DISPLAYBASE","12410"
 "GATCON","CATGAT2","LS(SOLD,2,CSTLN)","8","O","DISPLAYBASE","12410"
 "GATCON","CATGAT3","LS(SOLD,2,CSTLN);SY(GATCON04)","8","O","DISPLAYBASE","12410"
 "GATCON","CATGAT4","LS(SOLD,2,CSTLN);SY(GATCON03)","8","O","DISPLAYBASE","12410"
 "GATCON","CATGAT5","LS(SOLD,2,CSTLN)","8","O","DISPLAYBASE","12410"
 "LNDARE","","CS(QUAPOS01);TX(OBJNAM,1,1,2,'15110',0,1,CHBLK,26)","8","O","DISPLAYBASE","12010"
 "LNDELV","","LS(SOLD,1,LANDF)","4","O","OTHER","32010"
 "LNDMRK","","LS(SOLD,1,LANDF)","4","O","OTHER","32220"
 "LNDMRK","CONVIS1","LS(SOLD,1,CHBLK)","4","O","STANDARD","22220"
 "LOCMAG","","LS(DASH,1,CHMGF);SY(LOCMAG01)","4","S","OTHER","31080"
 "M_SREL","","LS(SOLD,2,CHMGF);SY(MAGVAR51);TE('varn %s','VALMAG',3,1,2,'15110',1,-1,CHBLK,27)","4","O","OTHER","31080"
 "MARCUL","","LS(DASH,2,CHGRF)","4","O","STANDARD","26210"
 "MORFAC","","LS(SOLD,2,CSTLN)","6","O","DISPLAYBASE","12410"
 "MORFAC","CATMOR4","LS(SOLD,2,CSTLN)","6","O","DISPLAYBASE","12410"
 "MORFAC","CATMOR6","LS(DASH,1,CHMGF)","6","O","DISPLAYBASE","14010"
 "NAVLNE","","LS(DASH,1,CHGRD)","4","O","STANDARD","25010"
 "NAVLNE","CATNAV1","LS(DASH,1,CHGRD);TE(%03.0lf deg,'ORIENT',1,1,2,'15110',0,-1,CHBLK,11)","4","O","STANDARD","25010"
 "NAVLNE","CATNAV2","LS(DASH,1,CHGRD);TE(%03.0lf deg,'ORIENT',1,1,2,'15110',0,-1,CHBLK,11)","4","O","STANDARD","25010"
 "NEWOBJ","","LC(NEWOBJ01)","6","S","STANDARD","21020"
 "NEWOBJ","SYMINS","CS(SYMINS01)","6","S","STANDARD","21020"
 "OBSTRN","","CS(OBSTRN06)","4","O","OTHER","34050"
 "OBSTRN","CATOBS8","LS(DASH,1,CSTLN)","4","O","DISPLAYBASE","12410"
 "OBSTRN","CATOBS9","LS(DASH,1,CHMGD)","4","O","DISPLAYBASE","12410"
 "OBSTRN","CATOBS10","LS(DASH,1,CSTLN)","4","O","DISPLAYBASE","12410"
 "OBSTRN","WATLEV7","LS(DASH,1,CSTLN)","4","O","DISPLAYBASE","12410"
 "OILBAR","","LS(DASH,1,CHBLK)","4","O","DISPLAYBASE","12410"
 "PIPOHD","","LS(SOLD,3,CHGRD);TE('clr %4.1lf','VERCLR',3,1,2,'15110',1,-1,CHBLK,11)","8","O","DISPLAYBASE","12210"
 "PIPOHD","CONRAD1","LS(SOLD,3,CHGRD);SY(RACNSP01);TE('clr %4.1lf','VERCLR',3,1,2,'15110',1,-1,CHBLK,11)","8","O","DISPLAYBASE","12210"
 "PIPOHD","CONRAD3","LS(SOLD,3,CHGRD);SY(RACNSP01);TE('clr %4.1lf','VERCLR',3,1,2,'15110',1,-1,CHBLK,11)","8","O","DISPLAYBASE","12210"

"PIPSOL", "", "LC(PIPSOL05)", "6", "O", "OTHER", "34070"
 "PIPSOL", "PRODUCT3", "LC(PIPSOL06)", "6", "O", "OTHER", "34070"
 "PIPSOL", "CATPIP2", "LC(PIPSOL06)", "6", "O", "OTHER", "34070"
 "PIPSOL", "CATPIP3", "LC(PIPSOL06)", "6", "O", "OTHER", "34070"
 "PIPSOL", "CATPIP4", "LC(PIPSOL06)", "6", "O", "OTHER", "34070"
 "PIPSOL", "CATPIP5", "LC(PIPSOL06)", "6", "O", "OTHER", "34070"
 "PONTON", "", "LS(SOLD,2,CSTLN)", "5", "O", "DISPLAYBASE", "12410"
 "RADLNE", "", "LS(DASH,2,TRFCD);TE(%03.0lf deg', 'ORIENT', 1,1,2,'15110',0,-1,CHBLK,11)", "6", "O", "STANDARD", "25040"
 "RAILWAY", "", "LS(SOLD,2,LANDF)", "4", "O", "OTHER", "32250"
 "RAPIDS", "", "LS(SOLD,3,CHGRD)", "3", "O", "OTHER", "32050"
 "RCRTCL", "", "LC(RCRDEF11);TE(%03.0lf deg', 'ORIENT', 1,1,2,'15110',0,-1,CHBLK,11)", "6", "O", "STANDARD", "25020"
 "RCRTCL", "CATTRK1TRAFIC1", "LC(RCRTCL14);TE(%03.0lf deg', 'ORIENT', 1,1,2,'15110',0,-1,CHBLK,11)", "6", "O", "STANDARD", "25020"
 "RCRTCL", "CATTRK1TRAFIC2", "LC(RCRTCL14);TE(%03.0lf deg', 'ORIENT', 1,1,2,'15110',0,-1,CHBLK,11)", "6", "O", "STANDARD", "25020"
 "RCRTCL", "CATTRK1TRAFIC3", "LC(RCRTCL14);TE(%03.0lf deg', 'ORIENT', 1,1,2,'15110',0,-1,CHBLK,11)", "6", "O", "STANDARD", "25020"
 "RCRTCL", "CATTRK1TRAFIC4", "LC(RCRTCL13);TE(%03.0lf deg', 'ORIENT', 1,1,2,'15110',0,-1,CHBLK,11)", "6", "O", "STANDARD", "25020"
 "RCRTCL", "CATTRK2TRAFIC1", "LC(RCRTCL12);TE(%03.0lf deg', 'ORIENT', 1,1,2,'15110',0,-1,CHBLK,11)", "6", "O", "STANDARD", "25020"
 "RCRTCL", "CATTRK2TRAFIC2", "LC(RCRTCL12);TE(%03.0lf deg', 'ORIENT', 1,1,2,'15110',0,-1,CHBLK,11)", "6", "O", "STANDARD", "25020"
 "RCRTCL", "CATTRK2TRAFIC3", "LC(RCRTCL12);TE(%03.0lf deg', 'ORIENT', 1,1,2,'15110',0,-1,CHBLK,11)", "6", "O", "STANDARD", "25020"
 "RCRTCL", "CATTRK2TRAFIC4", "LC(RCRTCL11);TE(%03.0lf deg', 'ORIENT', 1,1,2,'15110',0,-1,CHBLK,11)", "6", "O", "STANDARD", "25020"
 "RCRTCL", "TRAFIC1", "LC(RCRTCL12);TE(%03.0lf deg', 'ORIENT', 1,1,2,'15110',0,-1,CHBLK,11)", "6", "O", "STANDARD", "25020"
 "RCRTCL", "TRAFIC2", "LC(RCRTCL12);TE(%03.0lf deg', 'ORIENT', 1,1,2,'15110',0,-1,CHBLK,11)", "6", "O", "STANDARD", "25020"
 "RCRTCL", "TRAFIC3", "LC(RCRTCL12);TE(%03.0lf deg', 'ORIENT', 1,1,2,'15110',0,-1,CHBLK,11)", "6", "O", "STANDARD", "25020"
 "RCRTCL", "TRAFIC4", "LC(RCRTCL11);TE(%03.0lf deg', 'ORIENT', 1,1,2,'15110',0,-1,CHBLK,11)", "6", "O", "STANDARD", "25020"
 "RDOCAL", "", "LS(DASH,1,TRFCD);SY(RCLDEF01);TE('Nr %s', 'OBJNAM', 3,2,2,'15110',1,-1,CHBLK,21)", "6", "O", "STANDARD", "25060"
 "RDOCAL", "TRAFIC1ORIENT", "LS(DASH,1,TRFCD);SY(RDOCAL02,ORIENT);TE('Nr %s', 'OBJNAM', 3,1,2,'15110',1,-1,CHBLK,21);TE('ch %s', 'COMCHA', 3,1,2,'15110',1,1,CHBLK,11)", "6", "O", "STANDARD", "25060"
 "RDOCAL", "TRAFIC2ORIENT", "LS(DASH,1,TRFCD);SY(RDOCAL02,ORIENT);TE('Nr %s', 'OBJNAM', 3,1,2,'15110',1,-1,CHBLK,21);TE('ch %s', 'COMCHA', 3,1,2,'15110',1,1,CHBLK,11)", "6", "O", "STANDARD", "25060"
 "RDOCAL", "TRAFIC3ORIENT", "LS(DASH,1,TRFCD);SY(RDOCAL02,ORIENT);TE('Nr %s', 'OBJNAM', 3,1,2,'15110',1,-1,CHBLK,21);TE('ch %s', 'COMCHA', 3,1,2,'15110',1,1,CHBLK,11)", "6", "O", "STANDARD", "25060"
 "RDOCAL", "TRAFIC4ORIENT", "LS(DASH,1,TRFCD);SY(RDOCAL03,ORIENT);TE('Nr %s', 'OBJNAM', 3,1,2,'15110',1,-1,CHBLK,21);TE('ch %s', 'COMCHA', 3,1,2,'15110',1,1,CHBLK,11)", "6", "O", "STANDARD", "25060"
 "RECTRC", "", "LC(RECDEF02);TE(%03.0lf deg', 'ORIENT', 1,1,2,'15110',0,-1,CHBLK,11)", "6", "O", "STANDARD", "25020"
 "RECTRC", "CATTRK1TRAFIC1", "LC(RECTRC12);TE(%03.0lf deg', 'ORIENT', 1,1,2,'15110',0,-1,CHBLK,11)", "6", "O", "STANDARD", "25020"
 "RECTRC", "CATTRK1TRAFIC2", "LC(RECTRC12);TE(%03.0lf deg', 'ORIENT', 1,1,2,'15110',0,-1,CHBLK,11)", "6", "O", "STANDARD", "25020"
 "RECTRC", "CATTRK1TRAFIC3", "LC(RECTRC12);TE(%03.0lf deg', 'ORIENT', 1,1,2,'15110',0,-1,CHBLK,11)", "6", "O", "STANDARD", "25020"
 "RECTRC", "CATTRK1TRAFIC4", "LC(RECTRC10);TE(%03.0lf deg', 'ORIENT', 1,1,2,'15110',0,-1,CHBLK,11)", "6", "O", "STANDARD", "25020"
 "RECTRC", "CATTRK2TRAFIC1", "LC(RECTRC11);TE(%03.0lf deg', 'ORIENT', 1,1,2,'15110',0,-1,CHBLK,11)", "6", "O", "STANDARD", "25020"
 "RECTRC", "CATTRK2TRAFIC2", "LC(RECTRC11);TE(%03.0lf deg', 'ORIENT', 1,1,2,'15110',0,-1,CHBLK,11)", "6", "O", "STANDARD", "25020"
 "RECTRC", "CATTRK2TRAFIC3", "LC(RECTRC11);TE(%03.0lf deg', 'ORIENT', 1,1,2,'15110',0,-1,CHBLK,11)", "6", "O", "STANDARD", "25020"
 "RECTRC", "CATTRK2TRAFIC4", "LC(RECTRC09);TE(%03.0lf deg', 'ORIENT', 1,1,2,'15110',0,-1,CHBLK,11)", "6", "O", "STANDARD", "25020"
 "RECTRC", "TRAFIC1", "LC(RECTRC11);TE(%03.0lf deg', 'ORIENT', 1,1,2,'15110',0,-1,CHBLK,11)", "6", "O", "STANDARD", "25020"
 "RECTRC", "TRAFIC2", "LC(RECTRC11);TE(%03.0lf deg', 'ORIENT', 1,1,2,'15110',0,-1,CHBLK,11)", "6", "O", "STANDARD", "25020"
 "RECTRC", "TRAFIC3", "LC(RECTRC11);TE(%03.0lf deg', 'ORIENT', 1,1,2,'15110',0,-1,CHBLK,11)", "6", "O", "STANDARD", "25020"
 "RECTRC", "TRAFIC4", "LC(RECTRC09);TE(%03.0lf deg', 'ORIENT', 1,1,2,'15110',0,-1,CHBLK,11)", "6", "O", "STANDARD", "25020"
 "RIVERS", "", "LS(SOLD,1,CHBLK)", "2", "O", "DISPLAYBASE", "12420"
 "ROADWAY", "", "LS(SOLD,2,LANDF)", "4", "O", "OTHER", "32250"
 "RUNWAY", "", "LS(SOLD,3,LANDF)", "6", "O", "OTHER", "32240"
 "SBDARE", "", "LS(SOLD,1,CHGRD);TX(NATSUR,1,2,2,'15110',0,0,CHBLK,25)", "4", "O", "OTHER", "34010"

```
"SLCONS", "", "CS(SLCONS03)", "7", "O", "DISPLAYBASE", "12410"
"SLOTOP", "", "LS(SOLD,1,LANDF)", "4", "O", "OTHER", "32010"
"SLOTOP", "CATSLO2CONRAD1", "LS(SOLD,1,CHBLK)", "4", "O", "STANDARD", "22210"
"SLOTOP", "CATSLO6CONRAD1", "LS(SOLD,1,CHBLK)", "4", "O", "STANDARD", "22210"
"SLOTOP", "CATSLO6CONVIS1", "LS(SOLD,1,CHBLK)", "4", "O", "STANDARD", "22210"
"SLOTOP", "CATSLO2", "LS(SOLD,1,CHGRD)", "4", "O", "OTHER", "32010"
"SLOTOP", "CATSLO6", "LS(SOLD,1,CHGRD)", "4", "O", "OTHER", "32010"
"SNDWAV", "", "LS(DASH,2,CHGRD);SY(SNDWAV02)", "4", "O", "STANDARD", "24010"
"STSLNE", "", "LS(DASH,1,CHGRF)", "3", "O", "OTHER", "36050"
"TIDEWY", "", "LS(SOLD,1,CHGRF)", "3", "O", "OTHER", "32070"
"TSLENE", "", "LS(SOLD,6,TRFCF)", "8", "O", "STANDARD", "25010"
"TSSBND", "", "LS(DASH,4,TRFCD)", "7", "O", "STANDARD", "25010"
"TUNNEL", "", "LS(DASH,1,CHGRD)", "4", "O", "OTHER", "32250"
"TUNNEL", "BURDEP0", "LS(DASH,2,CHBLK)", "4", "O", "STANDARD", "24010"
"VEGATN", "", "LS(DASH,1,LANDF)", "3", "O", "OTHER", "32030"
"WATFAL", "", "LS(SOLD,3,CHGRF)", "3", "O", "OTHER", "32050"
"WATFAL", "CONVIS1", "LS(SOLD,3,CHWHT)", "3", "O", "OTHER", "32050"
"WATTUR", "", "LS(DASH,1,CHGRD);SY(WATTUR02)", "4", "O", "OTHER", "33040"
*
```

```
* ***
* ***
* *** section two: NON-STANDARD CLASSES ***
* ***
* ***
*
```

*Note: category "DISPLAYBASE" should not be removed from the display.
*For non-standard classes, all category "MARINERS STANDARD" and "MARINERS OTHER"
*should be drawn when "STANDARD DISPLAY" is drawn, and thereafter may be re-assigned
*to the category of chosen by the mariner.
*

```
"clrlin", "", "CS(CLRLIN01)", "9", "O", "MARINERS OTHER", "53020"
"dnght", "", "LS(SOLD,3,DNGHL)", "8", "O", "MARINERS STANDARD", "53010"
"ebline", "", "CS(VRMEBL01)", "9", "O", "MARINERS OTHER", "61010"
"leglin", "", "CS(LEGLIN03)", "8", "O", "DISPLAYBASE", "42210"
"marfea", "", "LS(SOLD,2,NINFO);TX(OBJNAM,3,3,2,'15110',0,1,CHBLK,50)", "8", "O", "MARINERS OTHER", "53050"
"mnufea", "", "LS(SOLD,1,ADINF)", "5", "O", "MARINERS OTHER", "55010"
"pastrk", "", "CS(PASTRK01)", "3", "O", "MARINERS STANDARD", "52430"
"poslin", "", "LS(SOLD,1,NINFO);TX(loctim,3,1,2,'15110',0,-1,CHBLK,50)", "3", "O", "MARINERS OTHER", "62020"
"poslin", "transf2", "LS(SOLD,1,NINFO);TX(loctim,3,1,2,'15110',0,-1,CHBLK,50);TX('TPL',3,3,2,'15110',0,1,CHBLK,50)", "3", "O", "MARINERS OTHER", "62020"
"rngrng", "", "LS(SOLD,1,CURSR)", "9", "O", "MARINERS OTHER", "61030"
"vrmark", "", "CS(VRMEBL01)", "9", "O", "MARINERS OTHER", "61010"
"wholin", "", "LS(SOLD,2,NINFO);TX(loctim,3,3,2,'15110',0,1,CHBLK,50);TX(usrmrk,3,1,2,'15110',0,-1,CHBLK,50)", "8", "O", "MARINERS STANDARD", "52010"
*
```

```
* ***
* ***
* *** end of look-up table ***
* ***
* ***
```

11.3 Look-up Table Listing for Object Type Area 'A'

11.3.1 Look-up Table for areas with symbolized boundaries

```

* *** AREAS WITH SYMBOLIZED BOUNDARIES ***
* *** This is the look-up table for area symbolization. ***
* *** For edition 3.4 Preslib, dated January 2008 *****
*
* Each line contains minimum 6 fields:
* 1. field - code of the object class
* 2. field - attribute combination
* 3. field - symbolization instruction
* 4. field - display priority
* 5. field - radar
* 6. field - IMO display category
* 7. field - viewing group (optional)
*
* Each field entry is framed by '"' and fields are separated by ','.
*
* Please note, that the entries to this table must be in
* alphabetic order (sorted by the class code).
*
* This table has 2 sections:
*
* - The first section contains symbolization instructions for
* standard S-57 'real world' objects:
* - The second section contains symbolization instructions for
* non-standard (class code in lowercase) objects:
*
* default for symbolization failure; must be the first entry to look-up table
"#####", "", "SY(QUESMRK1);LC(QUESMRK1)", "5", "S", "STANDARD", "21010"
*
* *** ***
* *** section one: REAL WORLD CLASSES ***
* *** ***
*
"ACHARE", "", "SY(ACHARE51);LC(ACHARE51);CS(RESTRN01)", "3", "S", "STANDARD", "26220"
"ACHARE", "CATACH8", "SY(ACHARE02);LS(DASH,2,CHMGF);CS(RESTRN01)", "3", "S", "STANDARD", "26220"
"ACHBRT", "", "SY(ACHBRT07);TE('Nr %s',OBJNAM',3,1,2,'15110',1,0,CHBLK,29);LS(DASH,2,CHMGF)", "5", "S", "STANDARD", "26220"

```

"ADMARE", "", "LC(ADMARE01)", "2", "S", "OTHER", "36050"
 "AIRARE", "", "AP(AIRARE02);LS(SOLD,1,LANDF)", "2", "S", "OTHER", "32240"
 "AIRARE", "CONVIS1", "AC(LANDA);AP(AIRARE02);LS(SOLD,1,CHBLK)", "2", "S", "STANDARD", "22220"
 "ARCSLN", "", "LC(ARCSLN01)", "5", "S", "STANDARD", "26260"
 "BERTHS", "", "SY(BRTHNO01);TE('Nr %s', 'OBJNAM', 3, 1, 2, '15110', 1, 0, CHBLK, 29)", "3", "S", "OTHER", "32440"
 "BRIDGE", "", "TX(OBJNAM, 3, 1, 2, '15110', 1, 0, CHBLK, 21);TE('clr %4.1f', 'VERCLR', 3, 1, 2, '15110', 1, 1, CHBLK, 11);LS(SOLD, 4, CHGRD)", "8", "O", "DISPLAYBASE", "12210"
 "BRIDGE", "CATBRG2", "SY(BRIDGE01);TE('clr cl %4.1f', 'VERCCL', 3, 1, 2, '15110', 1, 0, CHBLK, 11);TE('clr op %4.1f', 'VERCOP', 3, 1, 2, '15110', 1, 1, CHBLK, 11);LS(SOLD, 4, CHGRD)", "8", "O", "DISPLAYBASE", "12210"
 "BRIDGE", "CATBRG3", "SY(BRIDGE01);TE('clr cl %4.1f', 'VERCCL', 3, 1, 2, '15110', 1, 0, CHBLK, 11);TE('clr op %4.1f', 'VERCOP', 3, 1, 2, '15110', 1, 1, CHBLK, 11);LS(SOLD, 4, CHGRD)", "8", "O", "DISPLAYBASE", "12210"
 "BRIDGE", "CATBRG4", "SY(BRIDGE01);TE('clr cl %4.1f', 'VERCCL', 3, 1, 2, '15110', 1, 0, CHBLK, 11);TE('clr op %4.1f', 'VERCOP', 3, 1, 2, '15110', 1, 1, CHBLK, 11);LS(SOLD, 4, CHGRD)", "8", "O", "DISPLAYBASE", "12210"
 "BRIDGE", "CATBRG5", "SY(BRIDGE01);TE('clr cl %4.1f', 'VERCCL', 3, 1, 2, '15110', 1, 0, CHBLK, 11);TE('clr op %4.1f', 'VERCOP', 3, 1, 2, '15110', 1, 1, CHBLK, 11);LS(SOLD, 4, CHGRD)", "8", "O", "DISPLAYBASE", "12210"
 "BRIDGE", "CATBRG7", "SY(BRIDGE01);TE('clr cl %4.1f', 'VERCCL', 3, 1, 2, '15110', 1, 0, CHBLK, 11);TE('clr op %4.1f', 'VERCOP', 3, 1, 2, '15110', 1, 1, CHBLK, 11);LS(SOLD, 4, CHGRD)", "8", "O", "DISPLAYBASE", "12210"
 "BRIDGE", "CATBRG8", "SY(BRIDGE01);TE('clr cl %4.1f', 'VERCCL', 3, 1, 2, '15110', 1, 0, CHBLK, 11);TE('clr op %4.1f', 'VERCOP', 3, 1, 2, '15110', 1, 1, CHBLK, 11);LS(SOLD, 4, CHGRD)", "8", "O", "DISPLAYBASE", "12210"
 "BUAARE", "", "AC(CHBRN);TX(OBJNAM, 1, 2, 3, '15110', 0, 0, CHBLK, 26);LS(SOLD, 1, LANDF)", "3", "S", "STANDARD", "22240"
 "BUISGL", "", "AC(CHBRN);LS(SOLD, 1, LANDF)", "4", "S", "OTHER", "32220"
 "BUISGL", "FUNCTN33CONVIS1", "AC(CHBRN);TX(OBJNAM, 1, 2, 2, '15110', 0, 0, CHBLK, 26);LS(SOLD, 1, CHBLK)", "4", "S", "STANDARD", "22220"
 "BUISGL", "FUNCTN33", "AC(CHBRN);TX(OBJNAM, 1, 2, 2, '15110', 0, 0, CHBLK, 26);LS(SOLD, 1, LANDF)", "4", "S", "OTHER", "32220"
 "BUISGL", "CONVIS1", "AC(CHBRN);LS(SOLD, 1, CHBLK)", "4", "S", "STANDARD", "22220"
 "CANALS", "", "AC(DEPVS);LS(SOLD, 1, CHBLK)", "2", "S", "DISPLAYBASE", "12420"
 "CANALS", "CONDTN", "AC(DEPVS);LS(DASH, 1, CHBLK)", "2", "S", "DISPLAYBASE", "12420"
 "CAUSWY", "", "AC(CHBRN);LS(SOLD, 1, CSTLN)", "5", "S", "STANDARD", "22010"
 "CAUSWY", "WATLEV4", "AC(DEPIT);LS(DASH, 2, CSTLN)", "5", "S", "STANDARD", "22010"
 "CBLARE", "", "SY(CBLARE51);LC(CBLARE51);CS(RESTRN01)", "3", "S", "STANDARD", "26230"
"CHKPNT", "", "SY(CHKPNT01)", "4", "S", "OTHER", "32410"
 "CHKPNT", "", "SY(POSGEN04)", "4", "S", "OTHER", "32410"
 "CONVYR", "", "TE('clr %4.1f', 'VERCLR', 3, 1, 2, '15110', 1, 0, CHBLK, 11);LS(SOLD, 3, CHGRD)", "8", "O", "DISPLAYBASE", "12210"
 "CONVYR", "CONRAD1", "SY(RACNSP01);TE('clr %4.1f', 'VERCLR', 3, 1, 2, '15110', 1, 0, CHBLK, 11);LS(SOLD, 3, CHGRD)", "8", "O", "DISPLAYBASE", "12210"
 "CONVYR", "CONRAD3", "SY(RACNSP01);TE('clr %4.1f', 'VERCLR', 3, 1, 2, '15110', 1, 0, CHBLK, 11);LS(SOLD, 3, CHGRD)", "8", "O", "DISPLAYBASE", "12210"
 "CONZNE", "", "LS(DASH, 2, CHGRF)", "2", "S", "OTHER", "36050"
 "COSARE", "", "LS(DASH, 2, CHGRF)", "2", "S", "OTHER", "36010"
 "CRANES", "", "AC(CHBRN);LS(SOLD, 1, LANDF)", "4", "S", "OTHER", "32440"
 "CRANES", "CONVIS1", "AC(CHBRN);LS(SOLD, 1, CHBLK)", "4", "S", "STANDARD", "22220"
 "CTNARE", "", "SY(CTNARE51);LC(CTNARE51)", "3", "S", "STANDARD", "26050"
 "CTSARE", "", "SY(INFARE51);LC(CTYARE51)", "3", "S", "STANDARD", "26250"
 "CUSZNE", "", "LS(DASH, 1, CHGRF)", "2", "S", "OTHER", "36020"
 "DAMCON", "", "AC(CHBRN);LS(SOLD, 1, LANDF)", "3", "S", "STANDARD", "22010"
 "DAMCON", "CATDAM3", "AC(CHBRN);LS(SOLD, 2, CSTLN)", "6", "S", "DISPLAYBASE", "12410"
 "DEPARE", "", "CS(DEPARE02)", "1", "S", "DISPLAYBASE", "13030"
 "DEPARE", "DRVAL1?DRVAL2?", "AC(NODTA);AP(PRTSUR01);LS(SOLD, 2, CHGRD)", "1", "S", "DISPLAYBASE", "13030"
 "DMPGRD", "", "SY(INFARE51);LC(CTYARE51);CS(RESTRN01)", "3", "S", "STANDARD", "26240"
 "DOCARE", "", "AC(DEPVS);TX(OBJNAM, 1, 2, 3, '15110', 0, 0, CHBLK, 26);LS(SOLD, 1, CHBLK)", "2", "S", "DISPLAYBASE", "12420"
 "DOCARE", "CONDTN", "AC(DEPVS);TX(OBJNAM, 1, 2, 3, '15110', 0, 0, CHBLK, 26);LS(DASH, 1, CHBLK)", "2", "S", "DISPLAYBASE", "12420"
 "DRGARE", "", "CS(DEPARE02)", "1", "S", "DISPLAYBASE", "13030"
 "DRYDOC", "", "AC(LANDA);LS(SOLD, 1, CSTLN)", "4", "S", "OTHER", "32440"

"DWRTPPT", "", "SY(TSLDEF51);SY(DWRTPPT51);LC(DWRUTE51);CS(RESTRN01)", "4", "S", "STANDARD", "25010"
 "DWRTPPT", "ORIENTTRAFIC1", "SY(TSSLPT51,ORIENT);SY(DWRTPPT51);LC(DWRUTE51);CS(RESTRN01)", "4", "S", "STANDARD", "25010"
 "DWRTPPT", "ORIENTTRAFIC2", "SY(TSSLPT51,ORIENT);SY(DWRTPPT51);LC(DWRUTE51);CS(RESTRN01)", "4", "S", "STANDARD", "25010"
 "DWRTPPT", "ORIENTTRAFIC3", "SY(TSSLPT51,ORIENT);SY(DWRTPPT51);LC(DWRUTE51);CS(RESTRN01)", "4", "S", "STANDARD", "25010"
 "DWRTPPT", "ORIENTTRAFIC4", "SY(DWRUTE51,ORIENT);SY(DWRTPPT51);LC(DWRUTE51);CS(RESTRN01)", "4", "S", "STANDARD", "25010"
 "DYKCON", "", "AC(CHBRN);LS(SOLD,1,LANDF)", "3", "S", "STANDARD", "22010"
 "EXEZNE", "", "LS(DASH,2,CHGRF)", "2", "S", "OTHER", "36050"
 "FAIRWY", "", "LC(NAVARE51);CS(RESTRN01)", "4", "S", "STANDARD", "26050"
 "FAIRWY", "ORIENTTRAFIC1", "SY(FAIRWY51,ORIENT);LC(NAVARE51);CS(RESTRN01)", "4", "S", "STANDARD", "26050"
 "FAIRWY", "ORIENTTRAFIC2", "SY(FAIRWY51,ORIENT);LC(NAVARE51);CS(RESTRN01)", "4", "S", "STANDARD", "26050"
 "FAIRWY", "ORIENTTRAFIC3", "SY(FAIRWY51,ORIENT);LC(NAVARE51);CS(RESTRN01)", "4", "S", "STANDARD", "26050"
 "FAIRWY", "ORIENTTRAFIC4", "SY(FAIRWY52,ORIENT);LC(NAVARE51);CS(RESTRN01)", "4", "S", "STANDARD", "26050"
 "FERYRT", "", "SY(FRYARE51);LC(NAVARE51)", "3", "S", "STANDARD", "26040"
 "FERYRT", "CATFRY2", "SY(FRYARE52);LC(NAVARE51)", "3", "S", "STANDARD", "26040"
 "FLODOC", "", "AC(CHBRN);LS(SOLD,2,CSTLN)", "5", "S", "DISPLAYBASE", "12410"
 "FORSTC", "", "AC(CHBRN);LS(SOLD,1,LANDF)", "4", "S", "OTHER", "32220"
 "FORSTC", "CONVIS1", "AC(CHBRN);LS(SOLD,1,CHBLK)", "4", "S", "STANDARD", "22220"
 "FRPARE", "", "LS(DASH,2,CHGRF)", "2", "S", "OTHER", "36020"
 "FSHFAC", "", "SY(FSHFAC02);LC(NAVARE51)", "4", "S", "OTHER", "34040"
 "FSHFAC", "CATFIF1", "SY(FSHFAC03);LC(NAVARE51)", "4", "S", "OTHER", "34040"
 "FSHFAC", "CATFIF2", "SY(FSHFAC02);LC(NAVARE51)", "4", "S", "OTHER", "34040"
 "FSHFAC", "CATFIF3", "SY(FSHFAC02);LC(NAVARE51)", "4", "S", "OTHER", "34040"
 "FSHFAC", "CATFIF4", "SY(FSHFAC02);LC(NAVARE51)", "4", "S", "OTHER", "34040"
 "FSHGDR", "", "SY(FSHGDR01);LS(DASH,2,CHGRF)", "3", "S", "STANDARD", "26210"
 "FSHZNE", "", "LS(DASH,2,CHGRF)", "2", "S", "OTHER", "36040"
 "GATCON", "", "AC(CHBRN);LS(SOLD,2,CSTLN)", "8", "S", "DISPLAYBASE", "12410"
"GRIDRN", "", "SY(GRIDRN01)", "5", "S", "OTHER", "32460"
 "GRIDRN", "", "LS(DASH,1,CHGRD)", "5", "S", "OTHER", "32460"
 "HRBARE", "", "LC(NAVARE51)", "2", "S", "OTHER", "36020"
 "HRBFAC", "", "SY(CHINFO07)", "4", "S", "OTHER", "32410"
 "HRBFAC", "CATHAF1", "SY(ROLROL01)", "4", "S", "OTHER", "32410"
 "HRBFAC", "CATHAF4", "SY(HRBFAC09)", "4", "S", "OTHER", "32410"
 "HRBFAC", "CATHAF5", "SY(SMCFAC02)", "4", "S", "OTHER", "32410"
 "HULKES", "", "AC(CHBRN);LS(SOLD,2,CSTLN)", "5", "S", "DISPLAYBASE", "12410"
 "ICEARE", "", "AC(NODTA);AP(ICEARE04);LS(DASH,1,CHGRD)", "3", "S", "DISPLAYBASE", "12410"
 "ICNARE", "", "SY(INFARE51);LC(CTYARE51);CS(RESTRN01)", "3", "S", "STANDARD", "26250"
 "ISTZNE", "", "SY(ITZARE51);LC(RESARE51);CS(RESTRN01)", "5", "S", "STANDARD", "25010"
 "LAKARE", "", "AC(DEPVS);LS(SOLD,1,CHBLK)", "2", "S", "STANDARD", "22010"
 "LNDARE", "", "AC(LANDA);TX(OBJNAM,1,2,3,'15110',-1,-1,CHBLK,26)", "1", "S", "DISPLAYBASE", "12010"
 "LNDMRK", "", "AC(CHBRN);LS(SOLD,1,LANDF)", "4", "S", "OTHER", "32220"
 "LNDMRK", "CATLMK17FUNCTN33CONVIS1", "AC(CHBRN);TX(OBJNAM,1,2,2,'15110',0,0,CHBLK,26);LS(SOLD,1,CHBLK)", "4", "S", "STANDARD", "22220"
 "LNDMRK", "CATLMK17FUNCTN33", "AC(CHBRN);TX(OBJNAM,1,2,2,'15110',0,0,CHBLK,26);LS(SOLD,1,LANDF)", "4", "S", "OTHER", "32220"
 "LNDMRK", "CONVIS1", "AC(CHBRN);LS(SOLD,1,CHBLK)", "4", "S", "STANDARD", "22220"
 "LNDRGN", "", "TX(OBJNAM,1,2,3,'15110',0,0,CHBLK,26)", "3", "S", "STANDARD", "21060"
 "LNDRGN", "CATLND2", "AP(MARSHES1)", "3", "S", "STANDARD", "21060"
 "LNDRGN", "CATLND12", "AP(MARSHES1)", "3", "S", "STANDARD", "21060"
 "LOCMAG", "", "SY(LOCMAG51);LC(NAVARE51)", "4", "S", "OTHER", "31080"
 "LOGPON", "", "SY(FLTHAZ02);LS(DASH,1,CHBLK)", "5", "S", "DISPLAYBASE", "12410"
 "LOKBSN", "", "AC(DEPVS);LS(SOLD,1,CHBLK)", "2", "S", "DISPLAYBASE", "12420"

"M_ACCY",,,,,,""
 "M_COVR",,,,,,"CS(DATCVR02)","1","S","OTHER","31040"
 "M_CSCL",,,,,,"CS(DATCVR02)","1","S","OTHER","31040"
 "M_HOPA",,,,,,""
 "M_NPUB",,,,,,""
 "M_NSYS",,,,,,"LC(MARSYS51)","4","S","STANDARD","27040"
 "M_NSYS",,"MARSYS1ORIENT","SY(DIRBOYA1,ORIENT);LC(NAVARE51)","4","S","STANDARD","27040"
 "M_NSYS",,"MARSYS2ORIENT","SY(DIRBOYB1,ORIENT);LC(NAVARE51)","4","S","STANDARD","27040"
 "M_NSYS",,"ORIENT","SY(DIRBOY01,ORIENT);LC(NAVARE51)","4","S","STANDARD","27040"
 "M_QUAL",,,,,,"AP(NODATA03);LS(DASH,2,CHGRD)","4","S","OTHER","31010"
 "M_QUAL",,"CATZOC1",,"AP(DQUALA11);LS(DASH,2,CHGRD)","4","S","OTHER","31010"
 "M_QUAL",,"CATZOC2",,"AP(DQUALA21);LS(DASH,2,CHGRD)","4","S","OTHER","31010"
 "M_QUAL",,"CATZOC3",,"AP(DQUALB01);LS(DASH,2,CHGRD)","4","S","OTHER","31010"
 "M_QUAL",,"CATZOC4",,"AP(DQUALC01);LS(DASH,2,CHGRD)","4","S","OTHER","31010"
 "M_QUAL",,"CATZOC5",,"AP(DQUALD01);LS(DASH,2,CHGRD)","4","S","OTHER","31010"
 "M_QUAL",,"CATZOC6",,"AP(DQUALU01);LS(DASH,2,CHGRD)","4","S","OTHER","31010"
 "M_SDAT",,,,,,""
 "M_SREL",,,,,,""
 "M_VDAT",,,,,,""
 "MAGVAR",,,,,,"SY(MAGVAR51)","4","S","OTHER","31080"
 "MARCUL",,,,,,"AP(MARCUL02);LC(NAVARE51);CS(RESTRN01)","3","S","STANDARD","26210"
 "MIPARE",,,,,,"SY(CTYARE51);LC(CTYARE51);CS(RESTRN01)","4","S","STANDARD","26040"
 "MORFAC",,,,,,"AC(CHBRN);LS(SOLD,1,CHBLK)","6","S","DISPLAYBASE","12410 "
 "NEWOBJ",,,,,,"SY(NEWOBJ01);LS(DASH,2,CHMGD)","6","S","STANDARD","21020"
 "NEWOBJ",,"SYMINS",,"CS(SYMINS01)","6","S","STANDARD","21020"
 "OBSTRN",,,,,,"CS(OBSTRN06)","4","S","OTHER","34050"
 "OBSTRN",,"CATOBS7VALSOU",,"SY(FOULGND1);LC(NAVARE51)","4","S","OTHER","34051"
 "OBSTRN",,"CATOBS7",,"SY(FOULGND1);LC(NAVARE51)","4","S","OTHER","34050"
 "OBSTRN",,"CATOBS8",,"SY(FLTHAZ02);LS(DASH,1,CSTLN)","4","S","DISPLAYBASE","12410"
 "OBSTRN",,"CATOBS9",,"SY(ACHARE02);LS(DASH,1,CHMGD)","4","S","DISPLAYBASE","12410"
 "OBSTRN",,"CATOBS10",,"SY(FLTHAZ02);LS(DASH,1,CSTLN)","4","S","DISPLAYBASE","12410"
 "OBSTRN",,"WATLEV7",,"SY(FLTHAZ02);LS(DASH,1,CSTLN)","4","S","DISPLAYBASE","12410"
 "OFSPLF",,,,,,"AC(CHBRN);LS(SOLD,4,CSTLN);TE('Prod %s',OBJNAM,3,1,2,'15110',1,-1,CHBLK,21)","5","O","DISPLAYBASE","12210"
 "OSPARE",,,,,,"SY(CTYARE51);LC(CTYARE51);CS(RESTRN01)","4","S","STANDARD","26040"
 "PILBOP",,,,,,"SY(PILBOP02);LC(CTYARE51)","4","S","STANDARD","28010"
 "PIPARE",,,,,,"SY(INFARE51);LC(PIPARE51);CS(RESTRN01)","3","S","STANDARD","26230"
 "PIPARE",,"CATPIP2",,"SY(INFARE51);LC(PIPARE61);CS(RESTRN01)","3","S","STANDARD","26230"
 "PIPARE",,"CATPIP3",,"SY(INFARE51);LC(PIPARE61);CS(RESTRN01)","3","S","STANDARD","26230"
 "PIPARE",,"PRODCT3",,"SY(INFARE51);LC(PIPARE61);CS(RESTRN01)","3","S","STANDARD","26230"
 "PONTON",,,,,,"AC(CHBRN);LS(SOLD,2,CSTLN)","5","S","DISPLAYBASE","12410"
 "PRCARE",,,,,,"AP(TSSJCT02);SY(PRCARE51);LC(PRCARE51);CS(RESTRN01)","4","S","STANDARD","25010"
 "PRDARE",,,,,,"LS(DASH,1,LANDF)","4","S","OTHER","32270"
 "PRDARE",,"CATPRA5CONVIS1",,"SY(RFNERY11);LS(DASH,1,CHBLK)","4","S","STANDARD","22220"
 "PRDARE",,"CATPRA8CONVIS1",,"SY(TNKFRM11);LS(DASH,1,CHBLK)","4","S","STANDARD","22220"
 "PRDARE",,"CATPRA9CONVIS1",,"SY(WNDFRM61);LS(DASH,1,CHBLK)","4","S","STANDARD","22220"
 "PRDARE",,"CATPRA1",,"SY(QUARRY01);LS(DASH,1,LANDF)","4","S","OTHER","32270"
 "PRDARE",,"CATPRA5",,"SY(RFNERY01);LS(DASH,1,LANDF)","4","S","OTHER","32270"
 "PRDARE",,"CATPRA6",,"SY(TMBYRD01);LS(DASH,1,LANDF)","4","S","OTHER","32270"
 "PRDARE",,"CATPRA8",,"SY(TNKFRM01);LS(DASH,1,LANDF)","4","S","OTHER","32270"

"PRDARE","CATPRA9","SY(WNDFRM51);LS(DASH,1,LANDF)","4","S","OTHER","32270"
 "PYLONS","","AC(CHBRN);LS(SOLD,2,CSTLN)","6","S","DISPLAYBASE","12210"
 "RADRNG","","LS(DASH,1,TRFCF)","3","S","STANDARD","25040"
 "RAPIDS","","AC(CHGRD)","3","S","OTHER","32050"
 "RCTLPT","","SY(RTLDEF51)","4","S","STANDARD","25020"
 "RCTLPT","ORIENT","SY(RCTLPT52,ORIENT)","4","S","STANDARD","25020"
 "RECTRC","","SY(RECDEF51);LC(NAVARE51)","6","S","STANDARD","25020"
 "RECTRC","ORIENTCATTRK1TRAFIC1","SY(RECTRC58,ORIENT);TE(%03.0lf deg','ORIENT',3,2,2,'15110',4,0,CHBLK,11);LC(NAVARE51)","6","S","STANDARD","25020"
 "RECTRC","ORIENTCATTRK1TRAFIC2","SY(RECTRC58,ORIENT);TE(%03.0lf deg','ORIENT',3,2,2,'15110',4,0,CHBLK,11);LC(NAVARE51)","6","S","STANDARD","25020"
 "RECTRC","ORIENTCATTRK1TRAFIC3","SY(RECTRC58,ORIENT);TE(%03.0lf deg','ORIENT',3,2,2,'15110',4,0,CHBLK,11);LC(NAVARE51)","6","S","STANDARD","25020"
 "RECTRC","ORIENTCATTRK1TRAFIC4","SY(RECTRC56,ORIENT);TE(%03.0lf deg','ORIENT',3,2,2,'15110',4,0,CHBLK,11);LC(NAVARE51)","6","S","STANDARD","25020"
 "RECTRC","ORIENTCATTRK2TRAFIC1","SY(RECTRC57,ORIENT);TE(%03.0lf deg','ORIENT',3,2,2,'15110',4,0,CHBLK,11);LC(NAVARE51)","6","S","STANDARD","25020"
 "RECTRC","ORIENTCATTRK2TRAFIC2","SY(RECTRC57,ORIENT);TE(%03.0lf deg','ORIENT',3,2,2,'15110',4,0,CHBLK,11);LC(NAVARE51)","6","S","STANDARD","25020"
 "RECTRC","ORIENTCATTRK2TRAFIC3","SY(RECTRC57,ORIENT);TE(%03.0lf deg','ORIENT',3,2,2,'15110',4,0,CHBLK,11);LC(NAVARE51)","6","S","STANDARD","25020"
 "RECTRC","ORIENTCATTRK2TRAFIC4","SY(RECTRC55,ORIENT);TE(%03.0lf deg','ORIENT',3,2,2,'15110',4,0,CHBLK,11);LC(NAVARE51)","6","S","STANDARD","25020"
 "RECTRC","ORIENTTTRAFIC1","SY(RECTRC57,ORIENT);TE(%03.0lf deg','ORIENT',3,2,2,'15110',4,0,CHBLK,11);LC(NAVARE51)","6","S","STANDARD","25020"
 "RECTRC","ORIENTTTRAFIC2","SY(RECTRC57,ORIENT);TE(%03.0lf deg','ORIENT',3,2,2,'15110',4,0,CHBLK,11);LC(NAVARE51)","6","S","STANDARD","25020"
 "RECTRC","ORIENTTTRAFIC3","SY(RECTRC57,ORIENT);TE(%03.0lf deg','ORIENT',3,2,2,'15110',4,0,CHBLK,11);LC(NAVARE51)","6","S","STANDARD","25020"
 "RECTRC","ORIENTTTRAFIC4","SY(RECTRC55,ORIENT);TE(%03.0lf deg','ORIENT',3,2,2,'15110',4,0,CHBLK,11);LC(NAVARE51)","6","S","STANDARD","25020"
 "RESARE","","CS(RESARE03)","5","S","STANDARD","26010"
 "RESARE","CATREA27","SY(ESSARE01);LC(ESSARE01)","5","S","STANDARD","26010"
 "RESARE","CATREA28","SY(PSSARE01);LC(ESSARE01)","5","S","STANDARD","26010"
 "RIVERS","","AC(DEPVS);LS(SOLD,1,CHBLK)","2","S","DISPLAYBASE","12420"
 "ROADWAY","","AC(LANDA);LS(SOLD,1,LANDF)","4","S","OTHER","32250"
 "RUNWAY","","AC(CHBRN)","5","S","OTHER","32240"
 "RUNWAY","CONVIS1","AC(CHBRN);LS(SOLD,1,CHBLK)","5","S","STANDARD","22220"
 "SBDARE","","TX(NATSUR,1,2,2,'15110',0,0,CHBLK,25)","3","O","OTHER","34010"
 "SBDARE","WATLEV3NATSUR","TX(NATSUR,1,2,2,'15110',0,0,CHBLK,25);LS(DASH,1,CHGRD)","3","S","OTHER","34010"
 "SBDARE","WATLEV4NATSUR9","AP(RCKLDG01);LS(DASH,1,CHGRD)","3","S","OTHER","34010"
 "SBDARE","WATLEV4NATSUR11","AP(RCKLDG01);LS(DASH,1,CHGRD)","3","S","OTHER","34010"
 "SBDARE","WATLEV4NATSUR14","AP(RCKLDG01);LS(DASH,1,CHGRD)","3","S","OTHER","34010"
 "SBDARE","WATLEV4NATSUR","TX(NATSUR,1,2,2,'15110',0,0,CHBLK,25);LS(DASH,1,CHGRD)","3","S","OTHER","34010"
 "SEAARE","","TX(OBJNAM,1,2,3,'15110',0,0,CHBLK,26)","3","S","STANDARD","21060"
 "SILTNK","","AC(CHBRN);LS(SOLD,1,LANDF)","4","S","OTHER","32220"
 "SILTNK","CONVIS1","AC(CHBRN);LS(SOLD,1,CHBLK)","4","S","STANDARD","22220"
 "SLCONS","","CS(SLCONS03)","7","S","DISPLAYBASE","12410"
 "SLOGRD","","AC(CHGRD);LS(SOLD,1,CHBLK)","3","S","OTHER","32010"
 "SMCFAC","","AC(CHBRN);SY(SMCFAC02);LS(SOLD,1,LANDF)","4","S","OTHER","38210"
 "SNDWAV","","AP(SNDWAV01);LC(NAVARE51)","4","S","STANDARD","24010"
 "SPLARE","","SY(CTYARE51);LC(CTYARE51);CS(RESTRN01)","4","S","STANDARD","26040"
 "SUBTLN","","SY(CTYARE51);LC(CTYARE51);CS(RESTRN01)","4","S","STANDARD","26040"
 "SWPARE","","SY(SWPARE51);TE('swept to %5.1lf','DRVAL1',1,2,2,'15110',0,1,CHBLK,27);LC(NAVARE51)","4","S","STANDARD","23030"
 "T_HMON","","SY(TIDEHT01);LC(TIDINF51)","2","S","OTHER","33050"
 "T_NHMN","","SY(TIDEHT01);LC(TIDINF51)","2","S","OTHER","33050"
 "T_TIMS","","SY(TIDEHT01);LC(TIDINF51)","2","S","OTHER","33050"
 "TS_FEB","","SY(CURDEF01);LC(TIDINF51)","2","S","OTHER","33060"
 "TS_FEB","CAT_TS1ORIENT","SY(FLDSTR01,ORIENT);TE(%4.1lf kn','CURVEL',3,1,2,'15110',1,-1,CHBLK,31)","4","S","OTHER","33060"

"TS_FEB","CAT_TS2ORIENT","SY(EBBSTR01,ORIENT);TE(%4.1lf kn','CURVEL',3,1,2,'15110',1,-1,CHBLK,31),"4","S","OTHER","33060"
 "TS_FEB","CAT_TS3ORIENT","SY(CURRENT01,ORIENT);TE(%4.1lf kn','CURVEL',3,1,2,'15110',1,-1,CHBLK,31),"4","S","OTHER","33060"
 "TS_PAD","SY(TIDSTR01);LC(TIDINF51),"2","S","OTHER","33060"
 "TS_PNH","SY(TIDSTR01);LC(TIDINF51),"2","S","OTHER","33060"
 "TS_PRH","SY(TIDSTR01);LC(TIDINF51),"2","S","OTHER","33060"
 "TS_TIS","SY(TIDSTR01);LC(TIDINF51),"2","S","OTHER","33060"
 "TESARE","LS(DASH,2,CHGRF);CS(RESTRN01),"2","S","OTHER","36050"
 "TIDEWY","LS(DASH,1,CHGRF);TX(OBJNAM,1,2,3,'15110',0,0,CHBLK,25),"7","S","OTHER","32070"
 "TSEZNE","AC(TRFCF,3),"4","S","STANDARD","25010"
 "TSSCRS","AP(TSSJCT02);SY(TSSCRS51);CS(RESTRN01),"6","S","STANDARD","25010"
 "TSSLPT","AP(TSSJCT02);SY(CTNARE51);TX(INFORM,1,1,2,'15110',0,-2,CHBLK,24);CS(RESTRN01),"6","S","STANDARD","25010"
 "TSSLPT","ORIENT","SY(TSSLPT51,ORIENT);CS(RESTRN01),"6","S","STANDARD","25010"
 "TSSRON","AP(TSSJCT02);SY(TSSRON51);CS(RESTRN01),"6","S","STANDARD","25010"
 "TUNNEL","LS(DASH,1,CHGRD),"4","S","OTHER","32250"
 "TUNNEL","BURDEPO","AC(DEPVS);LS(DASH,1,CHBLK),"4","S","STANDARD","24010"
 "TWRTP","SY(TWRDEF51);LC(CTYARE51),"4","S","STANDARD","25010"
 "TWRTP","ORIENTTRAFIC1","SY(TWRTP53,ORIENT);LC(CTYARE51),"4","S","STANDARD","25010"
 "TWRTP","ORIENTTRAFIC2","SY(TWRTP53,ORIENT);LC(CTYARE51),"4","S","STANDARD","25010"
 "TWRTP","ORIENTTRAFIC3","SY(TWRTP53,ORIENT);LC(CTYARE51),"4","S","STANDARD","25010"
 "TWRTP","ORIENTTRAFIC4","SY(TWRTP52,ORIENT);LC(CTYARE51),"4","S","STANDARD","25010"
 "UNSA","AC(NODTA);AP(NODATA03);LS(SOLD,2,CHGRD),"1","S","DISPLAYBASE","11050"
 "VEGATN","CATVEG7","AP(VEGATN04);LS(DASH,1,LANDF),"3","S","OTHER","32030"
 "VEGATN","CATVEG21","AP(VEGATN04);LS(DASH,1,LANDF),"3","S","OTHER","32030"
 "VEGATN","CATVEG3","AP(VEGATN03);LS(DASH,1,LANDF),"3","S","OTHER","32030"
 "VEGATN","CATVEG4","AP(VEGATN03);LS(DASH,1,LANDF),"3","S","OTHER","32030"
 "VEGATN","CATVEG5","AP(VEGATN03);LS(DASH,1,LANDF),"3","S","OTHER","32030"
 "VEGATN","CATVEG6","AP(VEGATN03);LS(DASH,1,LANDF),"3","S","OTHER","32030"
 "VEGATN","CATVEG13","AP(VEGATN03);LS(DASH,1,LANDF),"3","S","OTHER","32030"
 "VEGATN","CATVEG14","AP(VEGATN03);LS(DASH,1,LANDF),"3","S","OTHER","32030"
 "VEGATN","CATVEG15","AP(VEGATN03);LS(DASH,1,LANDF),"3","S","OTHER","32030"
 "VEGATN","CATVEG16","AP(VEGATN03);LS(DASH,1,LANDF),"3","S","OTHER","32030"
 "VEGATN","CATVEG17","AP(VEGATN03);LS(DASH,1,LANDF),"3","S","OTHER","32030"
 "VEGATN","CATVEG18","AP(VEGATN03);LS(DASH,1,LANDF),"3","S","OTHER","32030"
 "VEGATN","CATVEG19","AP(VEGATN03);LS(DASH,1,LANDF),"3","S","OTHER","32030"
 "VEGATN","CATVEG20","AP(VEGATN03);LS(DASH,1,LANDF),"3","S","OTHER","32030"
 "VEGATN","CATVEG22","AP(VEGATN03);LS(DASH,1,LANDF),"3","S","OTHER","32030"
 "WATTUR","SY(WATTUR02);LS(DASH,1,CHGRD),"4","S","OTHER","33040"
 "WEDKLP","SY(WEDKLP03);LS(DASH,1,CHGRF),"3","O","OTHER","34020"
 "WRECKS","CS(WRECKS04),"4","S","OTHER","34050"
 "WRECKS","CATWRK3VALSOU","LC(NAVARE51),"4","S","OTHER","34051"
 "WRECKS","CATWRK3","LC(NAVARE51),"4","S","OTHER","34050"
 *
 * * * * *
 * * * * * section two: NON-STANDARD CLASSES * * * * *
 * * * * *
 *

*Note: category "DISPLAYBASE" should not be removed from the display.
 *For non-standard classes, all category "MARINERS STANDARD" and "MARINERS OTHER"
 *should be drawn when "STANDARD DISPLAY" is drawn, and thereafter may be re-assigned
 *to the category of chosen by the mariner.

```
*
"dnghlt","","AC(DNGHL,3);LS(SOLD,3,DNGHL)","8","O","MARINERS STANDARD","53010"
"marfea","","AC(ADINF,3);TX(OBJNAM,1,2,3,'15110',0,0,CHBLK,50);LS(SOLD,2,NINFO);LS(SOLD,1,CHBLK);","8","S","MARINERS STANDARD","53050"
"mnufea","","LS(DASH,2,ADINF)","5","S","MARINERS STANDARD","55010"
*
* ***                ***
* *** end of look-up table ***
* ***                ***
```

11.3.2 Look-up Table for areas with plain boundaries

```
* *** AREAS WITH PLAIN BOUNDARIES                ***
* *** This is the look-up table for area symbolization. ***
* *** For edition 3.4 Preslib, dated January 2008      *****
*
* Each line contains minimum 6 fields:
* 1. field - code of the object class
* 2. field - attribute combination
* 3. field - symbolization instruction
* 4. field - display priority
* 5. field - radar
* 6. field - IMO display category
* 7. field - viewing group (optional)
*
* Each field entry is framed by "" and fields are separated by ','.
*
* Please note, that the entries to this table must be in
* alphabetic order (sorted by the class code).
*
* This table has 2 sections:
*
* - The first section contains symbolization instructions for
* standard S-57 'real world' objects:
* - The second section contains symbolization instructions for
* non-standard (class code in lowercase) objects:
*
```

"CTNARE", "", "SY(CTNARE51);LS(DASH,2,TRFCD)", "3", "S", "STANDARD", "26050"
 "CTSARE", "", "SY(INFARE51);LS(DASH,1,CHMGF)", "3", "S", "STANDARD", "26250"
 "CUSZNE", "", "LS(DASH,1,CHGRF)", "2", "S", "OTHER", "36020"
 "DAMCON", "", "AC(CHBRN);LS(SOLD,1,LANDF)", "3", "S", "STANDARD", "22010"
 "DAMCON", "CATDAM3", "AC(CHBRN);LS(SOLD,2,CSTLN)", "6", "S", "DISPLAYBASE", "12410"
 "DEPARE", "", "CS(DEPARE02)", "1", "S", "DISPLAYBASE", "13030"
 "DEPARE", "DRVAL1?DRVAL2?", "AC(NODTA);AP(PRTSUR01);LS(SOLD,2,CHGRD)", "1", "S", "DISPLAYBASE", "13030"
 "DMPGRD", "", "SY(INFARE51);LS(DASH,1,CHMGD);CS(RESTRN01)", "3", "S", "STANDARD", "26240"
 "DOCARE", "", "AC(DEPVS);TX(OBJNAM,1,2,3,15110,0,0,CHBLK,26);LS(SOLD,1,CHBLK)", "2", "S", "DISPLAYBASE", "12420"
 "DOCARE", "CONDTN", "AC(DEPVS);TX(OBJNAM,1,2,3,15110,0,0,CHBLK,26);LS(DASH,1,CHBLK)", "2", "S", "DISPLAYBASE", "12420"
 "DRGARE", "", "CS(DEPARE02)", "1", "S", "DISPLAYBASE", "13030"
 "DRYDOC", "", "AC(LANDA);LS(SOLD,1,CSTLN)", "4", "S", "OTHER", "32440"
 "DWRTPPT", "", "SY(TSLDEF51);SY(DWRTPPT51);LS(DASH,3,TRFCD);CS(RESTRN01)", "4", "S", "STANDARD", "15010 25010"
 "DWRTPPT", "ORIENTTRAFIC1", "SY(TSSLPT51,ORIENT);SY(DWRTPPT51);LS(DASH,3,TRFCD);CS(RESTRN01)", "4", "S", "STANDARD", "25010"
 "DWRTPPT", "ORIENTTRAFIC2", "SY(TSSLPT51,ORIENT);SY(DWRTPPT51);LS(DASH,3,TRFCD);CS(RESTRN01)", "4", "S", "STANDARD", "25010"
 "DWRTPPT", "ORIENTTRAFIC3", "SY(TSSLPT51,ORIENT);SY(DWRTPPT51);LS(DASH,3,TRFCD);CS(RESTRN01)", "4", "S", "STANDARD", "25010"
 "DWRTPPT", "ORIENTTRAFIC4", "SY(DWRUTE51,ORIENT);SY(DWRTPPT51);LS(DASH,3,TRFCD);CS(RESTRN01)", "4", "S", "STANDARD", "25010"
 "DYKCON", "", "AC(CHBRN);LS(SOLD,1,LANDF)", "3", "S", "STANDARD", "22010"
 "EXEZNE", "", "LS(DASH,2,CHGRF)", "2", "S", "OTHER", "36050"
 "FAIRWY", "", "LS(DASH,1,CHGRD);CS(RESTRN01)", "4", "S", "STANDARD", "26050"
 "FAIRWY", "ORIENTTRAFIC1", "SY(FAIRWY51,ORIENT);LS(DASH,1,CHGRD);CS(RESTRN01)", "4", "S", "STANDARD", "26050"
 "FAIRWY", "ORIENTTRAFIC2", "SY(FAIRWY51,ORIENT);LS(DASH,1,CHGRD);CS(RESTRN01)", "4", "S", "STANDARD", "26050"
 "FAIRWY", "ORIENTTRAFIC3", "SY(FAIRWY51,ORIENT);LS(DASH,1,CHGRD);CS(RESTRN01)", "4", "S", "STANDARD", "26050"
 "FAIRWY", "ORIENTTRAFIC4", "SY(FAIRWY52,ORIENT);LS(DASH,1,CHGRD);CS(RESTRN01)", "4", "S", "STANDARD", "26050"
 "FERYRT", "", "SY(FRYARE51);LS(DASH,2,CHMGD)", "3", "S", "STANDARD", "26040"
 "FERYRT", "CATFRY2", "SY(FRYARE52);LS(DASH,2,CHBLK)", "3", "S", "STANDARD", "26040"
 "FLODOC", "", "AC(CHBRN);LS(SOLD,2,CSTLN)", "5", "S", "DISPLAYBASE", "12410"
 "FORSTC", "", "AC(CHBRN);LS(SOLD,1,LANDF)", "4", "S", "OTHER", "32220"
 "FORSTC", "CONVIS1", "AC(CHBRN);LS(SOLD,1,CHBLK)", "4", "S", "STANDARD", "22220"
 "FRPARE", "", "LS(DASH,2,CHGRF)", "2", "S", "OTHER", "36020"
 "FSHFAC", "", "AP(FSHHAV02);LS(DASH,1,CHGRD)", "4", "S", "OTHER", "34040"
 "FSHFAC", "CATFIF1", "AP(FSHFAC03);LS(DASH,1,CHGRD)", "4", "S", "OTHER", "34040"
 "FSHFAC", "CATFIF2", "AP(FSHFAC04);LS(DASH,1,CHGRD)", "4", "S", "OTHER", "34040"
 "FSHFAC", "CATFIF3", "AP(FSHFAC04);LS(DASH,1,CHGRD)", "4", "S", "OTHER", "34040"
 "FSHFAC", "CATFIF4", "AP(FSHFAC04);LS(DASH,1,CHGRD)", "4", "S", "OTHER", "34040"
 "FSHGRD", "", "SY(FSHGRD01);LS(DASH,2,CHGRF)", "3", "S", "STANDARD", "26210"
 "FSHZNE", "", "LS(DASH,2,CHGRF)", "2", "S", "OTHER", "36040"
 "GATCON", "", "AC(CHBRN);LS(SOLD,2,CSTLN)", "8", "S", "DISPLAYBASE", "12410"
"GRIDRN", "", "SY(GRIDRN01)", "5", "S", "OTHER", "32460"
 "GRIDRN", "", "LS(DASH,1,CHGRD)", "5", "S", "OTHER", "32460"
 "HRBFAC", "", "LS(DASH,2,CHGRD)", "2", "S", "OTHER", "36020"
 "HRBFAC", "SY(CHINFO07)", "4", "S", "OTHER", "32410"
 "HRBFAC", "CATHAF1", "SY(ROLROL01)", "4", "S", "OTHER", "32410"
 "HRBFAC", "CATHAF4", "SY(HRBFAC09)", "4", "S", "OTHER", "32410"
 "HRBFAC", "CATHAF5", "SY(SMCFAC02)", "4", "S", "OTHER", "32410"
 "HULKES", "", "AC(CHBRN);LS(SOLD,2,CSTLN)", "5", "S", "DISPLAYBASE", "12410"
 "ICEARE", "", "AC(NODTA);AP(ICEARE04);LS(DASH,1,CHGRD)", "3", "S", "DISPLAYBASE", "12410"
 "ICNARE", "", "SY(INFARE51);LS(DASH,1,CHMGF);CS(RESTRN01)", "3", "S", "STANDARD", "26250"
 "ISTZNE", "", "SY(ITZARE51);LS(DASH,1,TRFCD);CS(RESTRN01)", "5", "S", "STANDARD", "25010"

"PIPARE", "CATPIP3", "SY(INFARE51);LS(DASH,2,CHGRD);CS(RESTRN01)", "3", "S", "STANDARD", "26230"
 "PIPARE", "PRODCT3", "SY(INFARE51);LS(DASH,2,CHGRD);CS(RESTRN01)", "3", "S", "STANDARD", "26230"
 "PONTON", "", "AC(CHBRN);LS(SOLD,2,CSTLN)", "5", "S", "DISPLAYBASE", "12410"
 "PRCARE", "", "SY(PRCARE51);LS(DASH,2,TRFCD);CS(RESTRN01)", "4", "S", "STANDARD", "25010"
 "PRDARE", "", "LS(DASH,1,LANDF)", "4", "S", "OTHER", "32270"
 "PRDARE", "CATPRA5CONVIS1", "SY(RFNERY11);LS(DASH,1,CHBLK)", "4", "S", "STANDARD", "22220"
 "PRDARE", "CATPRA8CONVIS1", "SY(TNKFRM11);LS(DASH,1,CHBLK)", "4", "S", "STANDARD", "22220"
 "PRDARE", "CATPRA9CONVIS1", "SY(WNDFRM61);LS(DASH,1,CHBLK)", "4", "S", "STANDARD", "22220"
 "PRDARE", "CATPRA1", "SY(QUARRY01);LS(DASH,1,LANDF)", "4", "S", "OTHER", "32270"
 "PRDARE", "CATPRA5", "SY(RFNERY01);LS(DASH,1,LANDF)", "4", "S", "OTHER", "32270"
 "PRDARE", "CATPRA6", "SY(TMBYRD01);LS(DASH,1,LANDF)", "4", "S", "OTHER", "32270"
 "PRDARE", "CATPRA8", "SY(TNKFRM01);LS(DASH,1,LANDF)", "4", "S", "OTHER", "32270"
 "PRDARE", "CATPRA9", "SY(WNDFRM51);LS(DASH,1,LANDF)", "4", "S", "OTHER", "32270"
 "PYLONS", "", "AC(CHBRN);LS(SOLD,2,CSTLN)", "6", "S", "DISPLAYBASE", "12210"
 "RADRNG", "", "LS(DASH,1,TRFCF)", "3", "S", "STANDARD", "25040"
 "RAPIDS", "", "AC(CHGRD)", "3", "S", "OTHER", "32050"
 "RCTLPT", "", "SY(RTLDEF51)", "4", "S", "STANDARD", "25020"
 "RCTLPT", "ORIENT", "SY(RCTLPT52,ORIENT)", "4", "S", "STANDARD", "25020"
 "RECTRC", "", "SY(RECDEF51);LS(DASH,1,CHGRD)", "6", "S", "STANDARD", "25020"
 "RECTRC", "ORIENTCATTRK1TRAFIC1", "SY(RECTRC58,ORIENT);TE(%03.0lf deg,'ORIENT',3,2,2,'15110',4,0,CHBLK,11);LS(DASH,1,CHGRD)", "6", "S", "STANDARD", "25020"
 "RECTRC", "ORIENTCATTRK1TRAFIC2", "SY(RECTRC58,ORIENT);TE(%03.0lf deg,'ORIENT',3,2,2,'15110',4,0,CHBLK,11);LS(DASH,1,CHGRD)", "6", "S", "STANDARD", "25020"
 "RECTRC", "ORIENTCATTRK1TRAFIC3", "SY(RECTRC58,ORIENT);TE(%03.0lf deg,'ORIENT',3,2,2,'15110',4,0,CHBLK,11);LS(DASH,1,CHGRD)", "6", "S", "STANDARD", "25020"
 "RECTRC", "ORIENTCATTRK1TRAFIC4", "SY(RECTRC56,ORIENT);TE(%03.0lf deg,'ORIENT',3,2,2,'15110',4,0,CHBLK,11);LS(DASH,1,CHGRD)", "6", "S", "STANDARD", "25020"
 "RECTRC", "ORIENTCATTRK2TRAFIC1", "SY(RECTRC57,ORIENT);TE(%03.0lf deg,'ORIENT',3,2,2,'15110',4,0,CHBLK,11);LS(DASH,1,CHGRD)", "6", "S", "STANDARD", "25020"
 "RECTRC", "ORIENTCATTRK2TRAFIC2", "SY(RECTRC57,ORIENT);TE(%03.0lf deg,'ORIENT',3,2,2,'15110',4,0,CHBLK,11);LS(DASH,1,CHGRD)", "6", "S", "STANDARD", "25020"
 "RECTRC", "ORIENTCATTRK2TRAFIC3", "SY(RECTRC57,ORIENT);TE(%03.0lf deg,'ORIENT',3,2,2,'15110',4,0,CHBLK,11);LS(DASH,1,CHGRD)", "6", "S", "STANDARD", "25020"
 "RECTRC", "ORIENTCATTRK2TRAFIC4", "SY(RECTRC55,ORIENT);TE(%03.0lf deg,'ORIENT',3,2,2,'15110',4,0,CHBLK,11);LS(DASH,1,CHGRD)", "6", "S", "STANDARD", "25020"
 "RECTRC", "ORIENTTRAFIC1", "SY(RECTRC57,ORIENT);TE(%03.0lf deg,'ORIENT',3,2,2,'15110',4,0,CHBLK,11);LS(DASH,1,CHGRD)", "6", "S", "STANDARD", "25020"
 "RECTRC", "ORIENTTRAFIC2", "SY(RECTRC57,ORIENT);TE(%03.0lf deg,'ORIENT',3,2,2,'15110',4,0,CHBLK,11);LS(DASH,1,CHGRD)", "6", "S", "STANDARD", "25020"
 "RECTRC", "ORIENTTRAFIC3", "SY(RECTRC57,ORIENT);TE(%03.0lf deg,'ORIENT',3,2,2,'15110',4,0,CHBLK,11);LS(DASH,1,CHGRD)", "6", "S", "STANDARD", "25020"
 "RECTRC", "ORIENTTRAFIC4", "SY(RECTRC55,ORIENT);TE(%03.0lf deg,'ORIENT',3,2,2,'15110',4,0,CHBLK,11);LS(DASH,1,CHGRD)", "6", "S", "STANDARD", "25020"
 "RESARE", "", "CS(RESARE03)", "5", "S", "STANDARD", "26010"
 "RESARE", "CATREA27", "SY(ESSARE01);LC(ESSARE01)", "5", "S", "STANDARD", "26010"
 "RESARE", "CATREA28", "SY(PSSARE01);LC(ESSARE01)", "5", "S", "STANDARD", "26010"
 "RIVERS", "", "AC(DEPVS);LS(SOLD,1,CHBLK)", "2", "S", "DISPLAYBASE", "12420"
 "ROADWY", "", "AC(LANDA);LS(SOLD,1,LANDF)", "4", "S", "OTHER", "32250"
 "RUNWAY", "", "AC(CHBRN)", "5", "S", "OTHER", "32240"
 "RUNWAY", "CONVIS1", "AC(CHBRN);LS(SOLD,1,CHBLK)", "5", "S", "STANDARD", "22220"
 "SBDARE", "", "TX(NATSUR,1,2,2,'15110',0,0,CHBLK,25)", "3", "O", "OTHER", "34010"
 "SBDARE", "WATLEV3NATSUR", "TX(NATSUR,1,2,2,'15110',0,0,CHBLK,25);LS(DASH,1,CHGRD)", "3", "S", "OTHER", "34010"
 "SBDARE", "WATLEV4NATSUR9", "AP(RCKLDG01);LS(DASH,1,CHGRD)", "3", "S", "OTHER", "34010"
 "SBDARE", "WATLEV4NATSUR11", "AP(RCKLDG01);LS(DASH,1,CHGRD)", "3", "S", "OTHER", "34010"
 "SBDARE", "WATLEV4NATSUR14", "AP(RCKLDG01);LS(DASH,1,CHGRD)", "3", "S", "OTHER", "34010"
 "SBDARE", "WATLEV4NATSUR", "TX(NATSUR,1,2,2,'15110',0,0,CHBLK,25);LS(DASH,1,CHGRD)", "3", "S", "OTHER", "34010"
 "SEARE", "", "TX(OBJNAM,1,2,3,'15110',0,0,CHBLK,26)", "3", "S", "STANDARD", "21060"
 "SILTNK", "", "AC(CHBRN);LS(SOLD,1,LANDF)", "4", "S", "OTHER", "32220"
 "SILTNK", "CONVIS1", "AC(CHBRN);LS(SOLD,1,CHBLK)", "4", "S", "STANDARD", "22220"
 "SLCONS", "", "CS(SLCONS03)", "7", "S", "DISPLAYBASE", "12410"
 "SLOGRD", "", "", "", "", ""

"SLOGRD","CATSLO6","AC(CHGRD)","3","S","OTHER","32010"
 "SMCFAC","","AC(CHBRN);SY(SMCFAC02);LS(SOLD,1,LANDF)","4","S","OTHER","38210"
 "SNDWAV","","AP(SNDWAV01);LS(DASH,2,CHGRD)","4","S","STANDARD","24010"
 "SPLARE","","SY(CTYARE51);LS(DASH,1,CHMGD);CS(RESTRN01)","4","S","STANDARD","26040"
 "SUBTLN","","SY(CTYARE51);LS(DASH,1,CHMGD);CS(RESTRN01)","4","S","STANDARD","26040"
 "SWPARE","","SY(SWPARE51);TE('swept to %5.1f','DRVAL1',1,2,2,'15110',0,1,CHBLK,27);LS(DASH,1,CHGRD)","4","S","STANDARD","23030"
 "T_HMON","","SY(TIDEHT01);LS(DASH,1,CHGRD)","2","S","OTHER","33050"
 "T_NHMN","","SY(TIDEHT01);LS(DASH,1,CHGRD)","2","S","OTHER","33050"
 "T_TIMS","","SY(TIDEHT01);LS(DASH,1,CHGRD)","2","S","OTHER","33050"
 "TS_FEB","","SY(CURDEF01);LS(DASH,1,CHGRD)","2","S","OTHER","33060"
 "TS_FEB","CAT_TS1ORIENT","SY(FLDSTR01,ORIENT);TE('%4.1f kn','CURVEL',3,1,2,'15110',1,-1,CHBLK,31)","4","S","OTHER","33060"
 "TS_FEB","CAT_TS2ORIENT","SY(EBBSTR01,ORIENT);TE('%4.1f kn','CURVEL',3,1,2,'15110',1,-1,CHBLK,31)","4","S","OTHER","33060"
 "TS_FEB","CAT_TS3ORIENT","SY(CURRENT01,ORIENT);TE('%4.1f kn','CURVEL',3,1,2,'15110',1,-1,CHBLK,31)","4","S","OTHER","33060"
 "TS_PAD","","SY(TIDSTR01);LS(DASH,1,CHGRD)","2","S","OTHER","33060"
 "TS_PNH","","SY(TIDSTR01);LS(DASH,1,CHGRD)","2","S","OTHER","33060"
 "TS_PRH","","SY(TIDSTR01);LS(DASH,1,CHGRD)","2","S","OTHER","33060"
 "TS_TIS","","SY(TIDSTR01);LS(DASH,1,CHGRD)","2","S","OTHER","33060"
 "TESARE","","LS(DASH,2,CHGRF);CS(RESTRN01)","2","S","OTHER","36050"
 "TIDEWY","","LS(DASH,1,CHGRF);TX(OBJNAM,1,2,3,'15110',0,0,CHBLK,25)","7","S","OTHER","32070"
 "TSEZNE","","AC(TRFCF,3)","4","S","STANDARD","25010"
 "TSSCRS","","AP(TSSJCT02);SY(TSSCRS51);CS(RESTRN01)","6","S","STANDARD","25010"
 "TSSLPT","","SY(CTNARE51);TX(INFORM,1,1,2,'15110',0,-2,CHBLK,24);CS(RESTRN01)","6","S","STANDARD","25010"
 "TSSLPT","ORIENT","SY(TSSLPT51,ORIENT);CS(RESTRN01)","6","S","STANDARD","25010"
 "TSSRON","","SY(TSSRON51);CS(RESTRN01)","6","S","STANDARD","25010"
 "TUNNEL","","LS(DASH,1,CHGRD)","4","S","OTHER","32250"
 "TUNNEL","BURDEPO","AC(DEPVS);LS(DASH,1,CHBLK)","4","S","STANDARD","24010"
 "TWRTPT","","SY(TWRDEF51);LS(DASH,4,TRFCD)","4","S","STANDARD","25010"
 "TWRTPT","ORIENTTRAFIC1","SY(TWRTPT53,ORIENT);LS(DASH,4,TRFCD)","4","S","STANDARD","25010"
 "TWRTPT","ORIENTTRAFIC2","SY(TWRTPT53,ORIENT);LS(DASH,4,TRFCD)","4","S","STANDARD","25010"
 "TWRTPT","ORIENTTRAFIC3","SY(TWRTPT53,ORIENT);LS(DASH,4,TRFCD)","4","S","STANDARD","25010"
 "TWRTPT","ORIENTTRAFIC4","SY(TWRTPT52,ORIENT);LS(DASH,4,TRFCD)","4","S","STANDARD","25010"
 "UNSARE","","AC(NODTA);AP(NODATA03);LS(SOLD,2,CHGRD)","1","S","DISPLAYBASE","11050"
 "VEGATN","","","
 "VEGATN","CATVEG7","AP(VEGATN04);LS(DASH,1,LANDF)","3","S","OTHER","32030"
 "VEGATN","CATVEG21","AP(VEGATN04);LS(DASH,1,LANDF)","3","S","OTHER","32030"
 "VEGATN","CATVEG3","AP(VEGATN03);LS(DASH,1,LANDF)","3","S","OTHER","32030"
 "VEGATN","CATVEG4","AP(VEGATN03);LS(DASH,1,LANDF)","3","S","OTHER","32030"
 "VEGATN","CATVEG5","AP(VEGATN03);LS(DASH,1,LANDF)","3","S","OTHER","32030"
 "VEGATN","CATVEG6","AP(VEGATN03);LS(DASH,1,LANDF)","3","S","OTHER","32030"
 "VEGATN","CATVEG13","AP(VEGATN03);LS(DASH,1,LANDF)","3","S","OTHER","32030"
 "VEGATN","CATVEG14","AP(VEGATN03);LS(DASH,1,LANDF)","3","S","OTHER","32030"
 "VEGATN","CATVEG15","AP(VEGATN03);LS(DASH,1,LANDF)","3","S","OTHER","32030"
 "VEGATN","CATVEG16","AP(VEGATN03);LS(DASH,1,LANDF)","3","S","OTHER","32030"
 "VEGATN","CATVEG17","AP(VEGATN03);LS(DASH,1,LANDF)","3","S","OTHER","32030"
 "VEGATN","CATVEG18","AP(VEGATN03);LS(DASH,1,LANDF)","3","S","OTHER","32030"
 "VEGATN","CATVEG19","AP(VEGATN03);LS(DASH,1,LANDF)","3","S","OTHER","32030"
 "VEGATN","CATVEG20","AP(VEGATN03);LS(DASH,1,LANDF)","3","S","OTHER","32030"
 "VEGATN","CATVEG22","AP(VEGATN03);LS(DASH,1,LANDF)","3","S","OTHER","32030"
 "WATTUR","","SY(WATTUR02);LS(DASH,1,CHGRD)","4","S","OTHER","33040"

Item No.PL03.4.d8.ad.3 Addition to PresLib symbol description (Users' Manual Addendum)
CHECKPOINT and GRIDIRON symbol

Symbol Name:	SY(CHKPNT01)
RN:	590

Symbol Explanation: customs symbo

Look up table affected: area symbols with plain boundaries
 area symbols with symbolized boundaries
 paper chart point symbols
 simplified point symbols

Pivot Point Column: 2.00
 Pivot Point Row: 2.00

Width of Bounding Box: 4.00
 Height of Bounding Box: 4.00

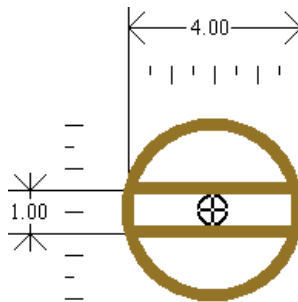

Symbol Colours: LANDF

Comments: Line weight 0.3 mm
 Circle diameter 4.00 mm

Examples on ENC: N/A

References:

S57	INT 1	
BUISGL	F 61	

Symbol Name: SY(**GRIDRN01**)
RN: 591

Symbol Explanation: gridiron

Look up table affected: area symbols with plain boundaries
area symbols with symbolized boundaries
paper chart point symbols
simplified point symbols

Pivot Point Column: 1.50
Pivot Point Row: 1.50

Width of Bounding Box: 3.00
Height of Bounding Box: 3.00

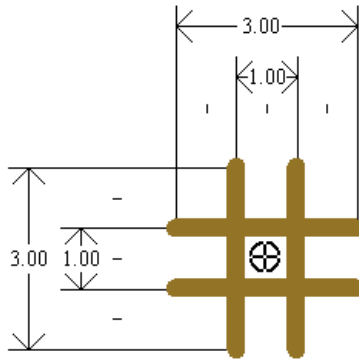

Symbol Colours: LANDF

Comments: Line weight 0.3 mm

Examples on ENC: N/A

References:

S57	INT 1	
GRIDRN	F 24	

Item No. PL03.4.d8.co.4 Correction and Addition to List of symbol names & meaning
correct several table entries

15.3/15.6 List of symbol names & meanings arranged numerically/alphabetically

Point symbols & centred area symbols (SY)

11.	SY(AISSLP01)	ARPATRESBLU	sleeping AIS target
12.	SY(AISVES01)	ARPATRESBLU	active AIS target showing vector and/or heading

Symbols added since Edition 3.0

580.	SY(AISLST01)	RESBLUDNGHL	lost AIS target
589.	SY(DGPS04DRFSTA01)	CHMGD	DGPS Base station